

RoHS  
COMPLIANT

◆ SPECIFICATIONS

- Current rating: 5A AC, DC
- Voltage rating: 250V AC, DC
- Temperature range: -40°C ~ +105°C
- Insulation resistance: 1000MΩ Min.
- Withstanding voltage: 1500V AC/ minute.
- Contact resistance: 10mΩ Max.

Material:

Insulator: LCP UL 94V-0  
 Contact: Brass/Matte-tin plated or selective gold plated over nickel  
 Solder nail: Brass/Matte-tin plated over nickel  
 Circuits: 2~12  
 Mate with KR3000 series single row Housing

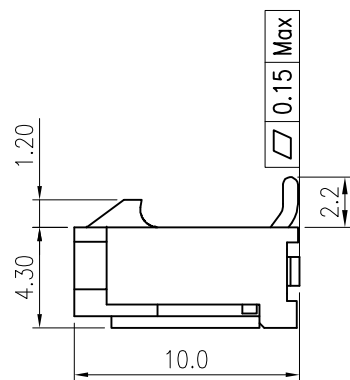
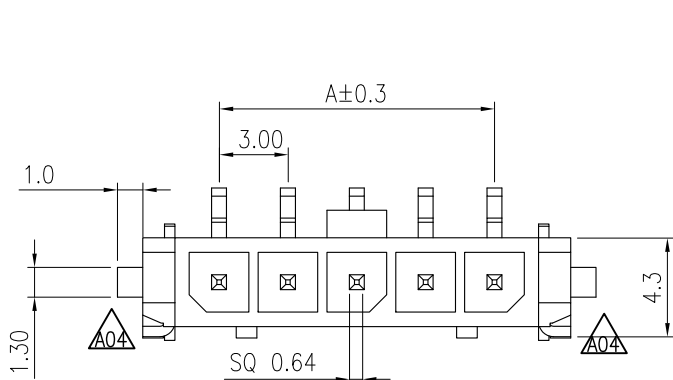

C3000VS 1\*\* 14 M0101 R A

No. of Circuits  
 102:2P  
 103:3P.....

Insulator Material  
 14:LCP Black

Packing  
 R: Reel Tape  
 P: Bag

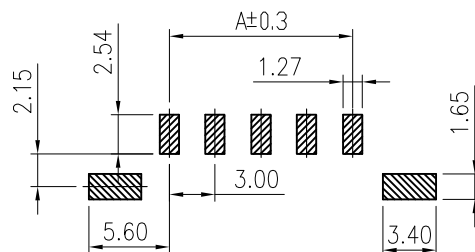
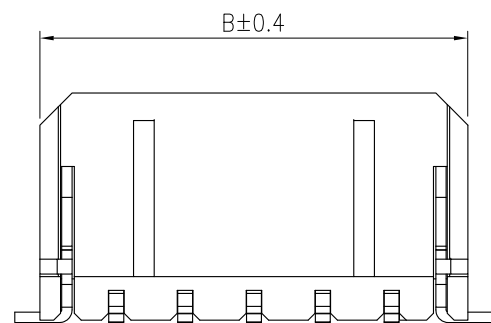

PCB LAYOUT

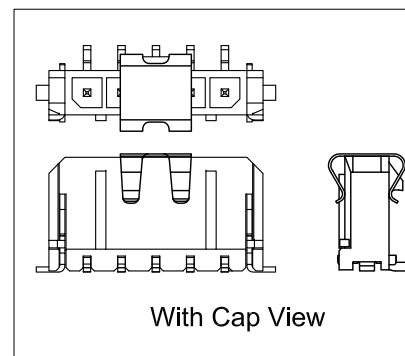

PIN NO.	Dimension mm	
	A	B
02P	3.0	9.7
03P	6.0	12.7
04P	9.0	15.7
05P	12.0	18.7
06P	15.0	21.7
07P	18.0	24.7
08P	21.0	27.7
09P	24.0	30.7
10P	27.0	33.7
11P	30.0	36.7
12P	33.0	39.7

With Cap View

	Correct view	ZSZ	2024.7.4	TOLERANCE	TITLE:	DRAWN: <i>ZSZ</i> 2024.07.04	KONNRA 东莞市康瑞电子有限公司 DongGuan Konnra Electronics Co.,Ltd.
	Uniformly arrange the drawings	Arvin	2021.9.30	X.X ±0.30	MX 3.0 SMT 180°	CHECKED:	
	Change the part number and frame format	Ru yi	2020.3.10	X.XX ±0.20	Wafer With Solder	APPROVED:	
MARK	REVISION DESCRIPTION	SIGNATURE	DATE	X.XXX ±0.10	Tab Single Row	PART NO.: C3000VS1**14***01RA	
				Angle ±2°	UNIT:mm SCALE:N/A	REV.: A04	DRAWING NO.: 3000WVS101-A-S