

SPECIFICATIONS  
 1. Current rating: 3.0A AC, DC  
 2. Voltage rating: 250V AC, DC  
 3. Temperature range: -40° C ~ +105° C  
 4. Insulation resistance: 1000M $\Omega$ /min.  
 5. Withstanding voltage: 500V AC/minute.  
 Material: Plastic(PA66)  
 Suitable:  
 KR2022 series terminal(22AWG~24AWG)  
 Mated with KR2021 series Wafer  
 Ordering Code: See BOM for details

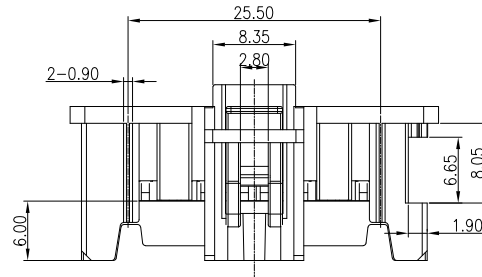
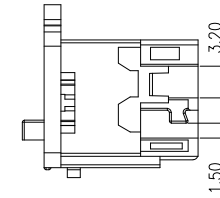
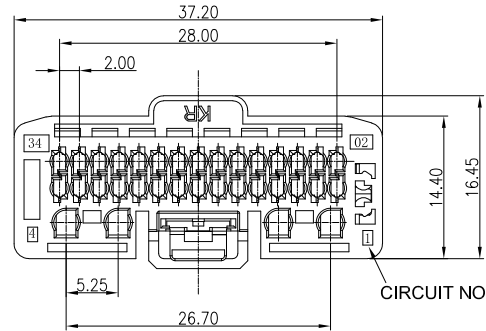
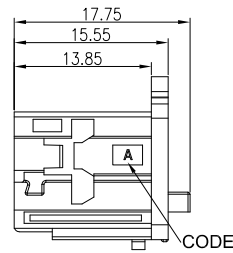
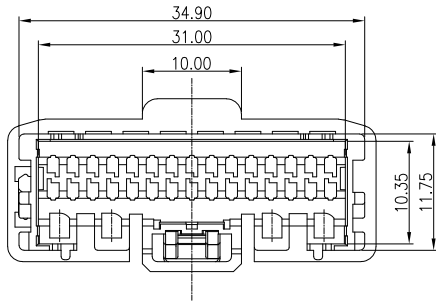
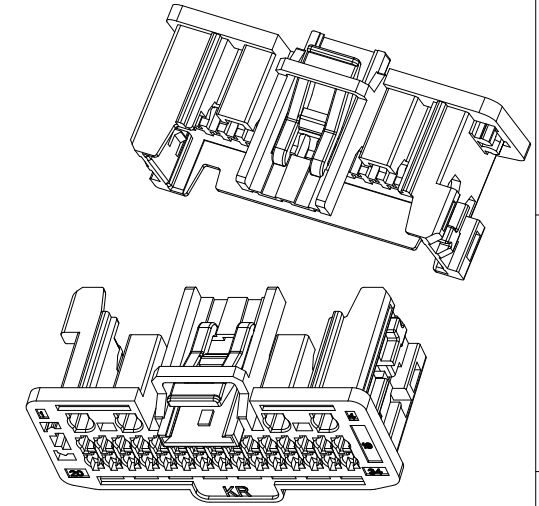
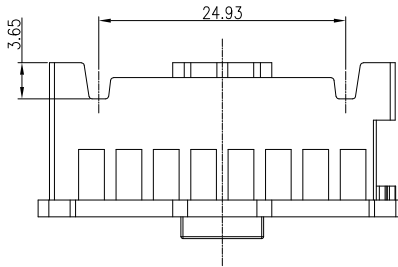

PART NO.	CIRCUIT	POL	COLOR
H202101342401A	34P	A	BLACK
H202101342402A	34P	B	GRAY
H202101342403A	34P	C	DARK GRAY
H202101382401A	38P	A	BLACK
H202101382402A	38P	B	GRAY
H202101382403A	38P	C	DARK GRAY

MARK	REVISION DESCRIPTION	SIGNATURE	DATE
$\triangle 3$			
$\triangle 2$			
$\triangle 1$	新图发行	Wesley	2023.05.25

GENERAL TOLERANCE	UNIT: mm	DATE
X.X $\pm 0.30$	DRAWN: Wesley	2023.05.25
X.XX $\pm 0.20$	CHECKED:	
X.XXX $\pm 0.10$	APPROVED:	
Angle $\pm 2^\circ$		

TITLE:
34/38 WAY MINI50 FEMALE
VER. A1
SCALE: 1:1
SHEET: 1/2

KONNRA 东莞市康瑞电子有限公司 DongGuan Konnra Electronics Co.,Ltd.		
PROJECT	PART NO.	H20210xxx240XA
DRAWING NO.		2021H401-A-S

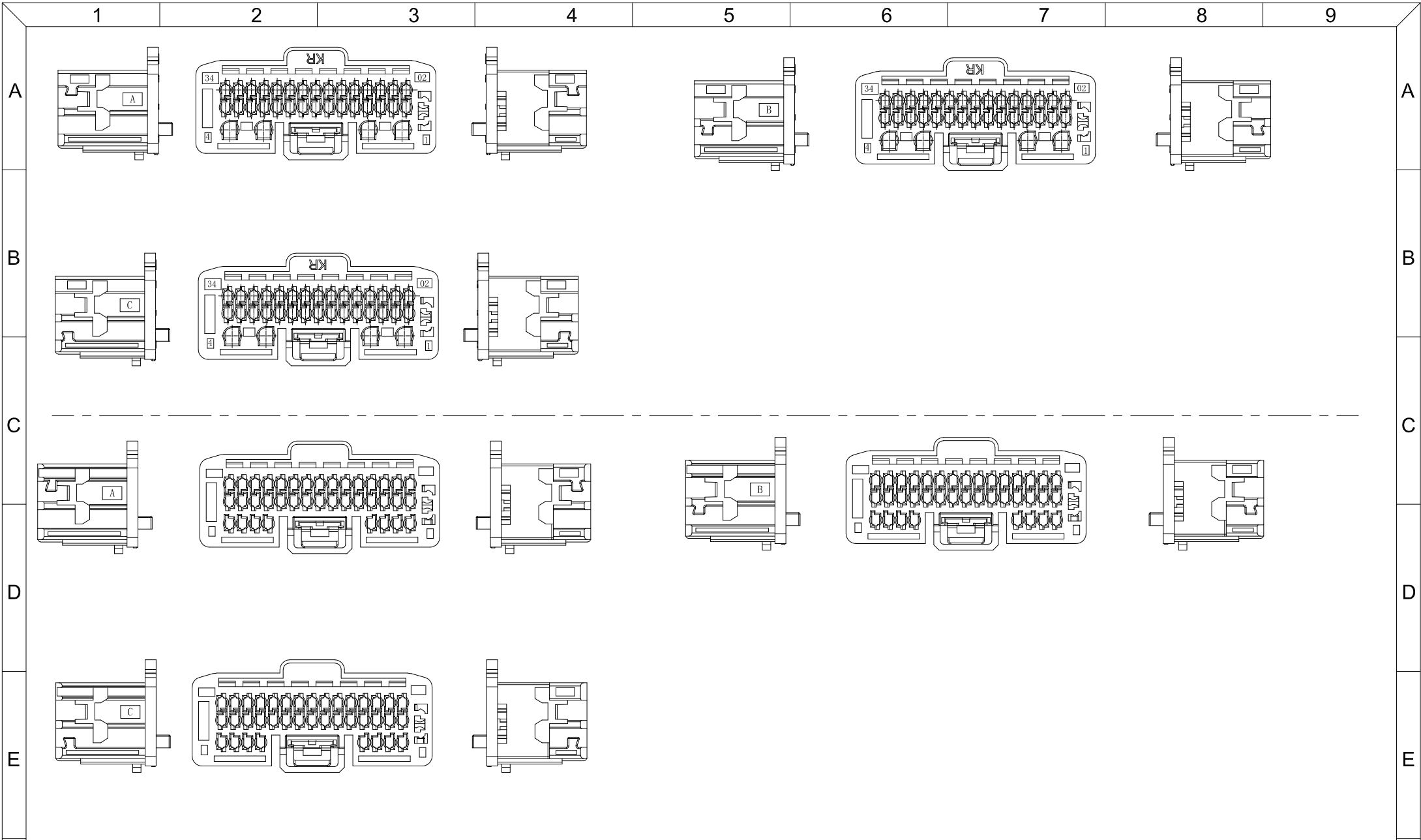

F					GENERAL TOLERANCE	UNIT: mm		DATE	TITLE:			<b>KONNRA</b> 东莞市康瑞电子有限公司 DongGuan Konnra Electronics Co.,Ltd.		
					X.X ±0.30	DRAWN: Wesley	2023.05.25	34/38 WAY MINI150 FEMALE						
		新图发行	Wesley	2023.05.25	X.XX ±0.20	CHECKED:		VER.	SCALE:	1:1	PROJECT	PART NO.	H20210xxx240XA	
	MARK	REVISION DESCRIPTION	SIGNATURE	DATE	X.XXX ±0.10	APPROVED:		A1	SHEET:	2/2		DRAWING NO.	2021H401-A-S	
	1	2	3	4	5	6	7	8	9					

SPECIFICATIONS

1. Current rating: 3.0A AC, DC
2. Voltage rating: 250V AC, DC
3. Temperature range: -40° C ~ +105° C
4. Insulation resistance: 1000MΩ / min.
5. Withstanding voltage: 500V AC / minute.

Material: Plastic (PA66)

Suitable:

KR2022 series terminal (22AWG~24AWG)

Mated with KR2021 series Wafer

Ordering Code: H202111\*\*\* 2401A

134=34P

138=38P

....

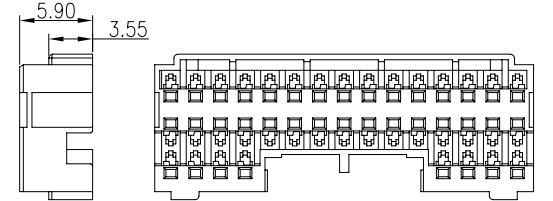
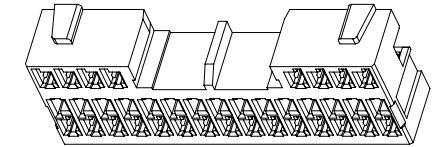
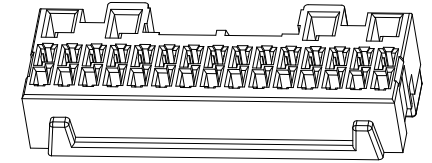
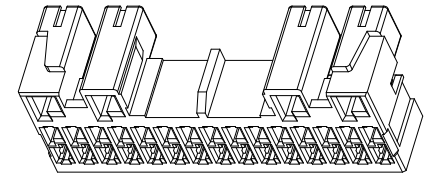
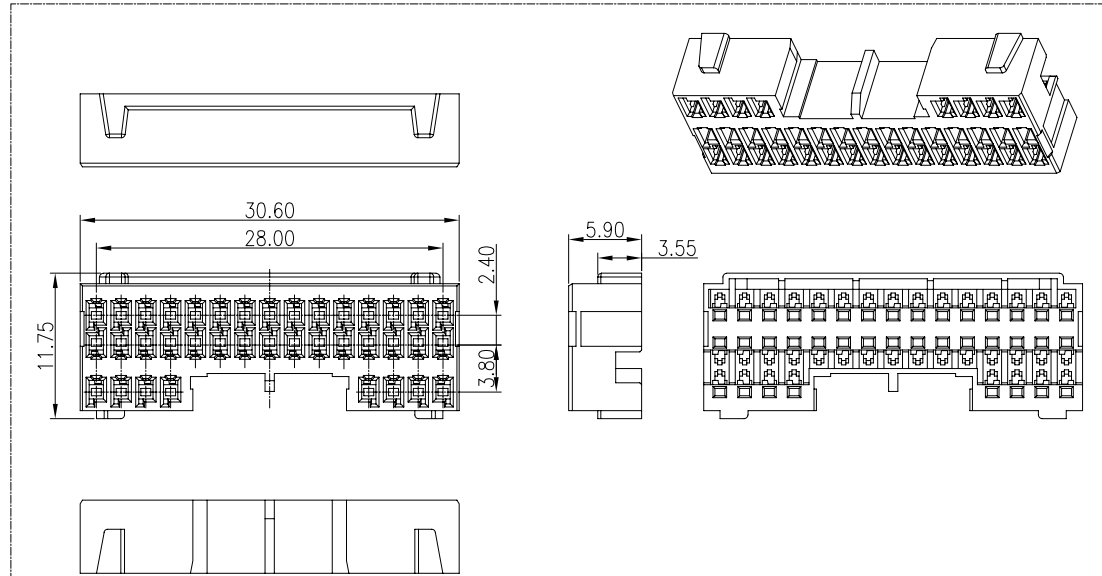
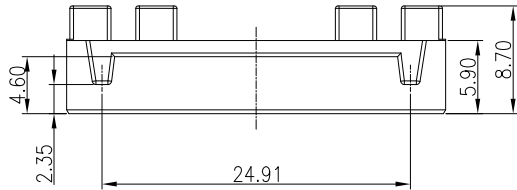
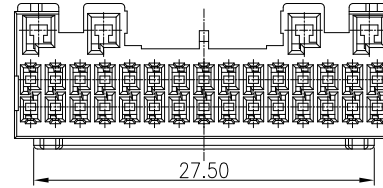
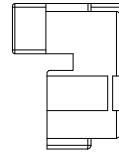
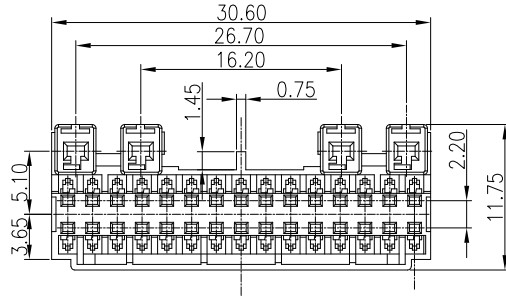
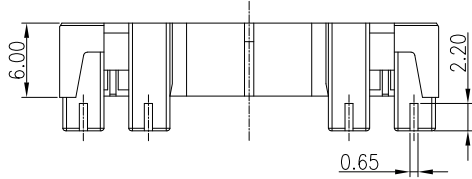
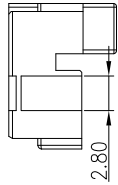

MARK

新图发行

Wesley

2023.05.25

1

2

3

4

5

6

7

8

9

GENERAL TOLERANCE

- X.X ±0.30
- X.XX ±0.20
- X.XXX ±0.10
- Angle ±2°

UNIT: mm

DRAWN: Wesley  
 CHECKED:  
 APPROVED:

DATE

2023.05.25

TITLE:

34/38 WAY MINI50  
 FEMALE 下壳

VER. A1 SCALE: 1:1  
 SHEET: 1/1

**KONNRA** 东莞市康瑞电子有限公司  
 DongGuan Konnra Electronics Co.,Ltd.

PROJECT PART NO. H20211xxx2401A

DRAWING NO. 2021H401-A-S

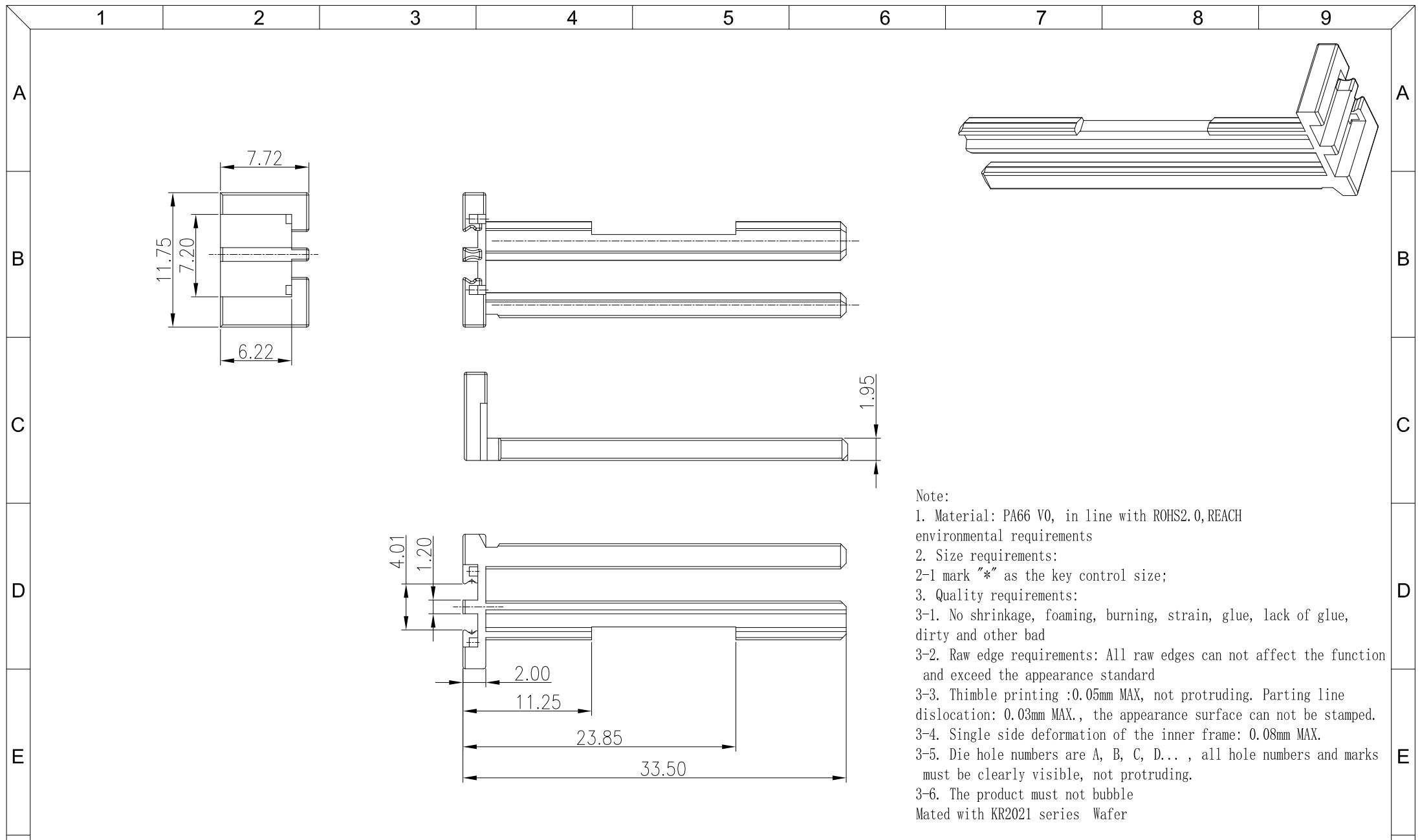

Note:

1. Material: PA66 V0, in line with ROHS2.0, REACH environmental requirements
2. Size requirements:  
2-1 mark "\*" as the key control size;
3. Quality requirements:  
3-1. No shrinkage, foaming, burning, strain, glue, lack of glue, dirty and other bad  
3-2. Raw edge requirements: All raw edges can not affect the function and exceed the appearance standard  
3-3. Thimble printing :0.05mm MAX., not protruding. Parting line dislocation: 0.03mm MAX., the appearance surface can not be stamped.  
3-4. Single side deformation of the inner frame: 0.08mm MAX.  
3-5. Die hole numbers are A, B, C, D... , all hole numbers and marks must be clearly visible, not protruding.  
3-6. The product must not bubble  
Mated with KR2021 series Wafer

A3				GENERAL TOLERANCE	UNIT: mm		DATE	TITLE:			KONNRA 东莞市康瑞电子有限公司 DongGuan Konnra Electronics Co.,Ltd.		
A2				X.X ±0.30	DRAWN:	Wesley	2023.05.25	34/38 WAY MINI50 FEMALE LOCK			PROJECT	PART NO.	H202121342401A
A1	新图发行	Wesley	2023.05.25	X.XX ±0.20	CHECKED:			VER.	SCALE:	1:1	DRAWING NO.	2021H401-A-S	
MARK	REVISION DESCRIPTION	SIGNATURE	DATE	X.XXX ±0.10	APPROVED:			A1	SHEET:	1/1			
1	2	3	4	5	6	7	8	9					

1	2	3	4	5	6	7	8	9
A	<p>Note:</p> <p>1. Material: PA66 V0, in line with ROHS2.0,REACH environmental requirements</p> <p>2. Size requirements: 2-1 mark "*" as the key control size;</p> <p>3. Quality requirements: 3-1. No shrinkage, foaming, burning, strain, glue, lack of glue, dirty and other bad</p> <p>3-2. Raw edge requirements: All raw edges can not affect the function and exceed the appearance standard</p> <p>3-3. Thimble printing :0.05mm MAX, not protruding. Parting line dislocation: 0.03mm MAX., the appearance surface can not be stamped.</p> <p>3-4. Single side deformation of the inner frame: 0.08mm MAX.</p> <p>3-5. Die hole numbers are A, B, C, D... , all hole numbers and marks must be clearly visible, not protruding.</p> <p>3-6. The product must not bubble</p> <p>Mated with KR2021 series Wafer</p>							A
B								B
C								C
D								D
E								E

F	A3							
A2				GENERAL TOLERANCE	UNIT: mm	DATE	TITLE:	KONNRA 东莞市康瑞电子有限公司
A1	新图发行	Wesley	2023.05.25	X.X ±0.30	DRAWN: Wesley	2023.05.25	34/38 WAY MINI50 FEMALE CPA	DongGuan Konnra Electronics Co.,Ltd.
MARK	REVISION DESCRIPTION	SIGNATURE	DATE	X.XX ±0.20	CHECKED:		VER. SCALE: 1:1	PROJECT PART NO. H202131342401A
1	2	3	4	5	6	7	8	9
							A1 SHEET: 1/1	DRAWING NO. 2021H401-A-Q