

RoHS
COMPLIANT

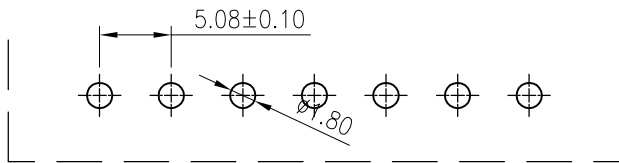
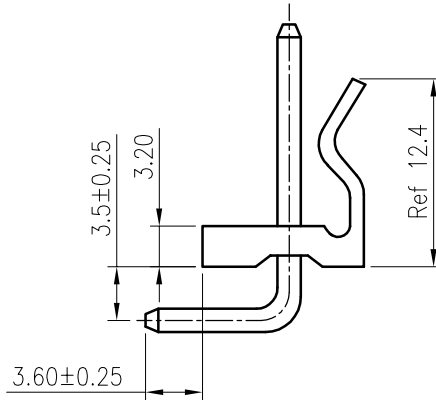
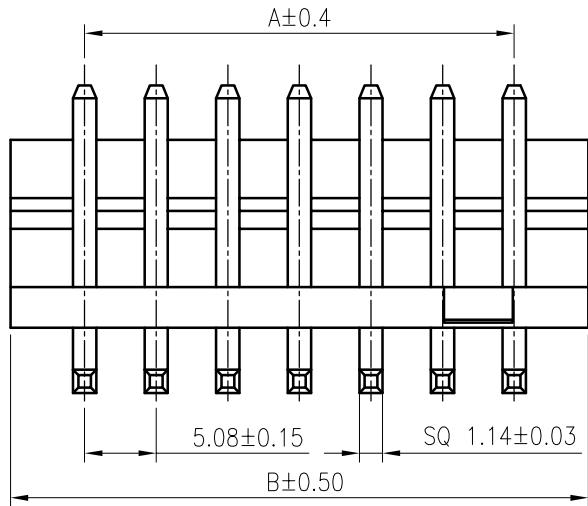
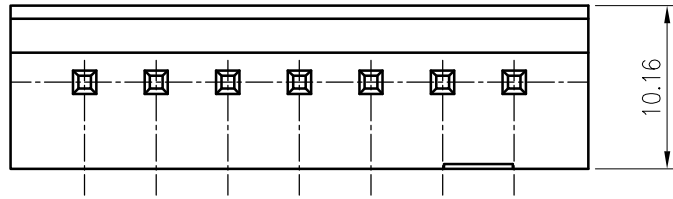

Recommended P.C.B. Layout
Total tolerance:±0.05mm

SPECIFICATIONS

1. Current rating: 7A AC, DC
2. Voltage rating: 250V AC, DC
3. Temperature range: -40°C ~ +105°C
4. Insulation resistance: 1000MΩ/ min.
5. Withstanding voltage: 1500V AC/ minute.
6. Contact resistance: 20mΩ/ max.

Material:

Insulator: PA66 UL94 V-2
Contact: Brass
Plating: Tin plated over Nickel
Mates With KR5081 Series Housing

Ordering Code:

C5081RD xxx 16 T01 01PB
No. of Circuits: 102:2, 114:14
Insulator Material: 16: PA66 Transparent
Plating: T01: Tin plated

Circuits	Dimensions		Circuits	Dimensions	
	A	B		A	B
2	5.08	10.16	9	40.64	45.72
3	10.16	15.24	10	45.72	50.80
4	15.24	20.32	11	50.80	55.88
5	20.32	25.40	12	55.88	60.96
6	25.40	30.48	13	60.96	66.04
7	30.48	35.56	14	66.04	71.12
8	35.56	40.64			

F	△3				TOLERANCE X. X ±0.30 X. XX ±0.20 X. XXX ±0.10 Angle ±2°	TITLE: MX5.08 DIP 90° Wafer curved back	DRAWN: Arvin 2020.03.24		KONNRA 东莞市康瑞电子有限公司 DongGuan Konnra Electronics Co., Ltd.		
	△2						CHECKED:				
	△1						APPROVED:		PART NO.: C5081RDxxx16T01PB		
	MARK	REVISION DESCRIPTION	SIGNATURE	DATE			UNIT: mm	SCALE: N/A	SHEET: 1/1	PROJECTION	REV.: A1
	1	2	3	4	5	6	7	8	9		