

RoHS
COMPLIANT

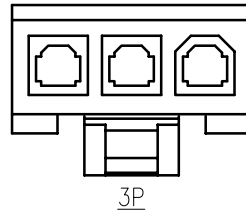
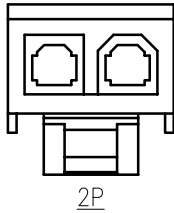
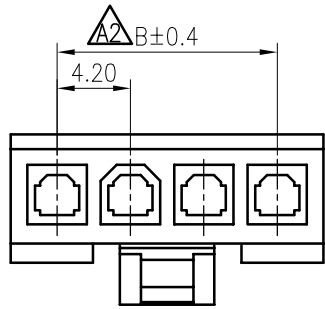

SPECIFICATIONS

1. Current rating: 9A(2P AWG#16) AC, DC
2. Voltage rating:600V AC,DC
3. Temperature range: -40°C ~ +105°C
4. Insulation resistance: 1000MΩ/ min.
5. Withstanding voltage: 1500V AC/ minute.
6. Contact resistance: 10mΩ/ max.

Material: Nylon 66 UL94 V-2 or V-0
Suitable KR4200 series female terminal
Mate with KR4200 series single row female housing or wafer

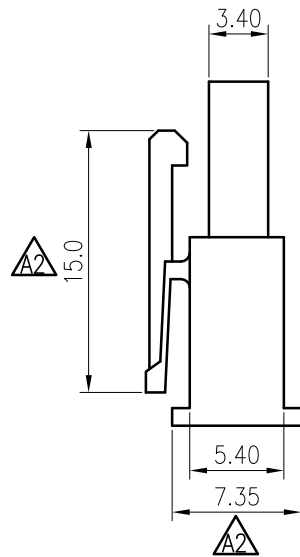
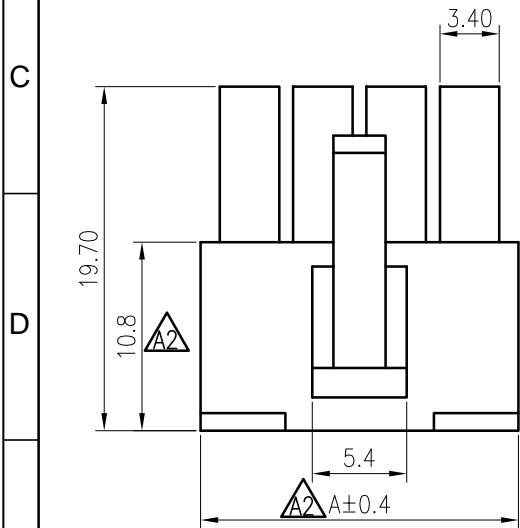

Ordering Code:

H4200M *** ** 01A
 No. of Circuits ————
 102:2,106:6
 Insulator Material ————
 01:PA66 White V0
 02:PA66 Black V0
 04:PA66 Black V2
 16:PA66 Transparent V2

Circuits	Dimensions	
	A	B
2	9.55	4.20
3	13.75	8.40
4	17.90	12.60
5	22.25	16.80
6	26.60	21.00

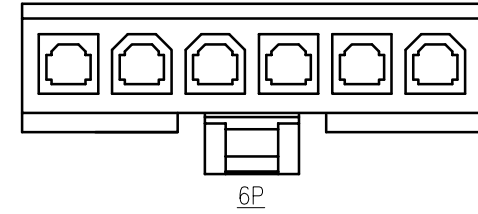
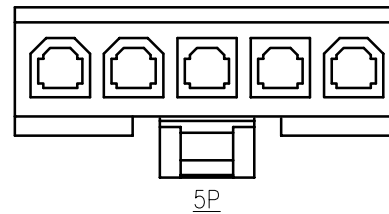

F					TOLERANCE X.X ±0.30 X.XX ±0.20 X.XXX ±0.10 Angle ±2°	TITLE: MK4.2 Single Row Male Housing	DRAWN: Arvin 2020.04.20		KONNRA 东莞市康瑞电子有限公司 DongGuan Konnra Electronics Co., Ltd.		
		Uniformly arrange the drawings	ZSZ	2022.01.16			CHECKED:				
		Change the part number and frame format	Arvin	2020.04.20			APPROVED:		PART NO. : H4200M xxx xx01A		
	MARK	REVISION DESCRIPTION	SIGNATURE	DATE			UNIT: mm	SCALE: N/A	SHEET: 1/1	PROJECTION	REV. : A4
	1	2	3	4	5	6	7	8	9		