

RoHS  
COMPLIANT

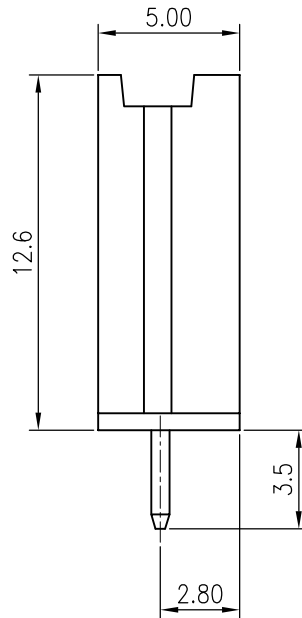
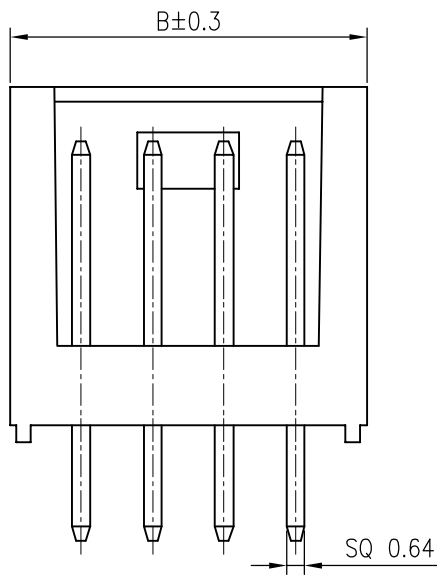
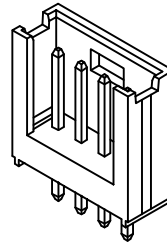
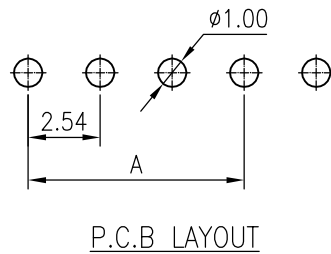
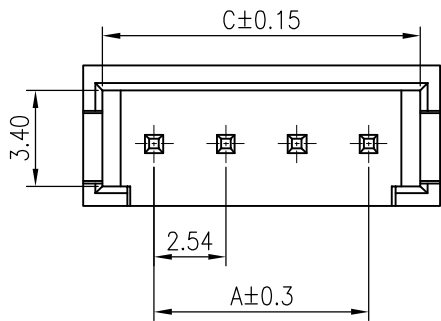

**SPECIFICATIONS**

Current rating: 3A AC, DC.  
Voltage rating: 250V AC, DC.  
Temperature range: -40°C ~ +105°C.  
Insulation resistance: 1000MΩ/ min.  
Withstanding voltage: 1000V AC/ minute.  
Contact resistance: 20mΩ / max.

**MATERIAL:**

Insulator: PA46 UL94V-0

Contact: BRASS /TIN-PLATED

MATES WITH KR2546 SERIES HOUSING

PART NO: C2546VD1\*\*08T0101PA   
 02: 2P  
 12: 12P  
 08: PA46黑色  
 T01: 亮锡  
 P: 袋装

PIN NO.	A	B	C
02	2.54	7.62	5.92
03	5.08	10.16	8.46
04	7.62	12.70	11.00
05	10.16	15.24	13.54
06	12.70	17.78	16.08
07	15.24	20.32	18.62
08	17.78	22.86	21.16
09	20.32	25.40	23.70
10	22.86	27.94	26.24
11	25.40	30.48	28.78
12	27.94	33.02	31.32



MARK

REVISION DESCRIPTION

SIGNATURE

DATE

TOLERANCE

X. X ±0.20

X. XX ±0.10

X. XXX ±0.05

Angle ±2°

TITLE:

2.54mm Pitch 180° Wafer

UNIT: mm

SCALE: N/A

DRAWN: ru yi 2020.03.10

CHECKED:

APPROVED:

SHEET: 1/1

PROJECTION 

**KONNRA** 东莞市康瑞电子有限公司

DongGuan Konnra Electronics Co., Ltd.

PART NO.: C2546VD1\*\*08T0101PA

REV.: A1

DRAWING NO.: 2546WDD01-A-S