

RoHS
COMPLIANT

SPECIFICATIONS

1. Current rating: 4A AC, DC
2. Voltage rating: 250V AC,DC
3. Temperature range: -40°C ~ +105°C
4. Insulation resistance: 1000MΩ Min.
5. Withstanding voltage: 1000V AC/ minute.
6. Contact resistance: 20mΩ Max.

Material:

Insulator: PA66 UL 94V-0
 Contact: Brass
 Plating: Tin plated over Nickel
 Mate with KR2540 series Housing
 Ordering Code:

C2540RD *** 22 T01 01 PA

No.of Circuits

102:2,115:15

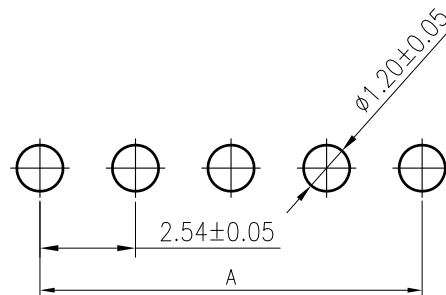
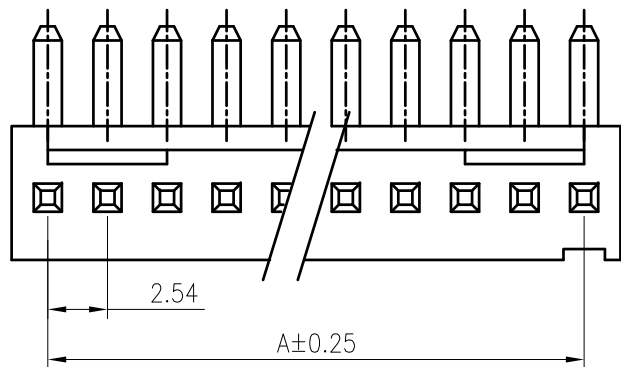

P.C.B LAYOUT

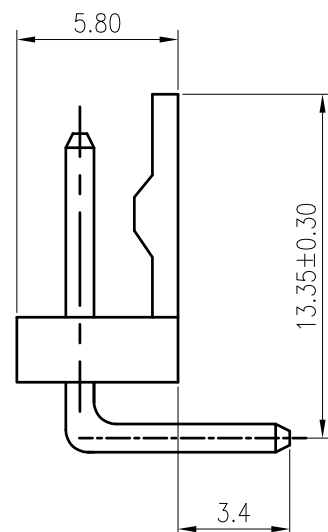
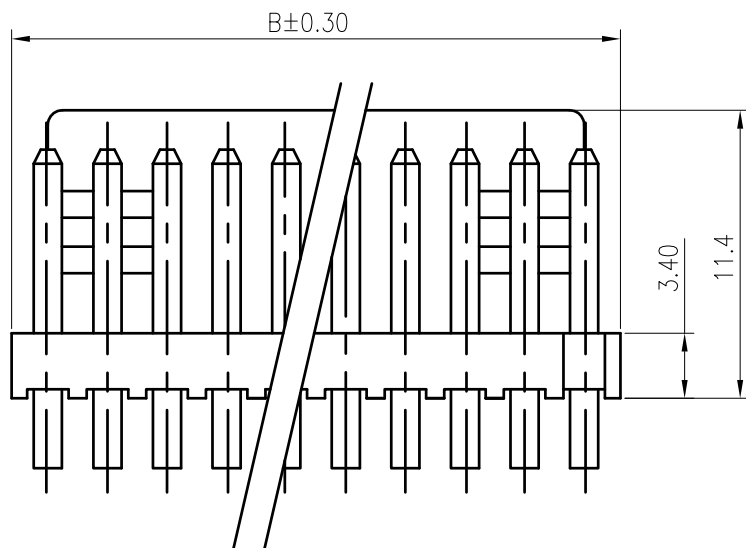

Circuits	Dimensions		Circuits	Dimensions	
	A	B		A	B
2	2.54	5.08	12	27.94	30.48
3	5.08	7.62	13	30.48	33.02
4	7.62	10.16	14	33.02	35.56
5	10.16	12.70	15	35.56	38.10
6	12.70	15.24	16	38.10	40.64
7	15.24	17.78	17	40.64	43.18
8	17.78	20.32	18	43.18	45.72
9	20.32	22.86	19	45.72	48.26
10	22.86	25.40	20	48.26	48.26
11	25.40	27.94			

TOLERANCE
 X.X ±0.30
 X.XX ±0.20
 X.XXX ±0.10
 Angle ±2°

TITLE:
 MX2510 DIP 90°
 Wafer

DRAWN: Arvin 2020.5.12

CHECKED:

APPROVED:

KONNRA 东莞市康瑞电子有限公司
 DongGuan Konnra Electronics Co.,Ltd.

PART NO.: C2540RD***22T0101PA

REV.: A2 DRAWING NO.: 2540WRD101-A-S



Uniformly arrange the drawings

Arvin 2020.05.12

MARK REVISION DESCRIPTION SIGNATURE DATE

UNIT:mm SCALE:N/A SHEET:1/1 PROJECTION

1

2

3

4

5

6

7

8

9