

**RoHS**  
COMPLIANT

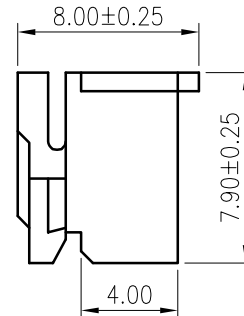
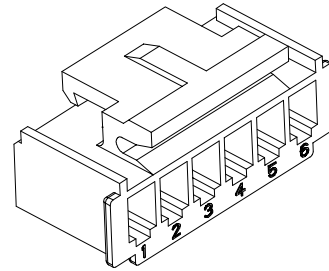
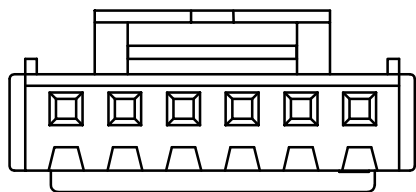
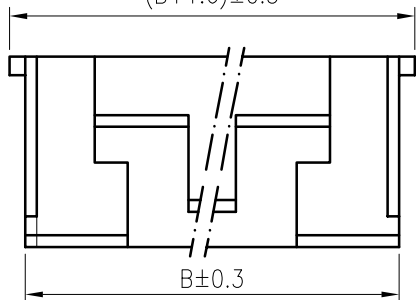
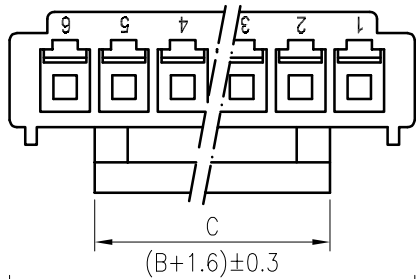
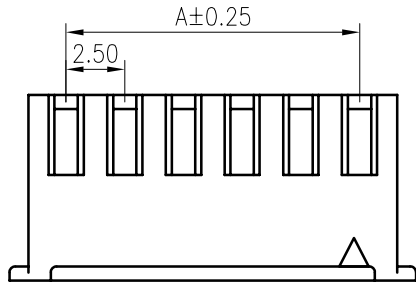

**SPECIFICATIONS**

1. Current rating: 3A AC, DC
2. Voltage rating: 250V AC, DC
3. Temperature range: -40°C ~ +105°C
4. Insulation resistance: 1000MΩ/ min.
5. Withstanding voltage: 1000V AC/ minute.
6. Contact resistance: 20mΩ/ max.

Material: PA66 UL94V-0  
Suitable KR2501 series terminal  
Mate with KR2511 series wafer

Ordering Code:

H25110 102 01 01A

No. of Circuits

102:2, 116:16

Insulator Material

01: PA66 White V0

Circuits	Dimensions		
	A	B	C
2	2.50	5.70	4.70
3	5.00	8.20	5.60
4	7.50	10.70	8.10
5	10.00	13.20	9.35
6	12.50	15.70	10.60
7	15.00	18.20	10.60
8	17.50	20.70	11.85
9	20.00	23.20	13.10
10	22.50	25.70	14.35
11	25.00	28.20	14.35
12	27.50	30.70	15.60
13	30.00	33.20	16.85
14	32.50	35.70	18.10
15	35.00	38.20	19.35
16	37.50	40.70	19.35

△4			
△3			
△2			
MARK	REVISION DESCRIPTION	SIGNATURE	DATE

TOLERANCE  
X. X ±0.30  
X. XX ±0.20  
X. XXX ±0.10  
Angle ±2°

TITLE:  
XHQ2.5 Housing

DRAWN: Arvin 2021.03.13

CHECKED:

APPROVED:

UNIT: mm SCALE: N/A

SHEET: 1/1

PROJECTION

**KONNRA** 东莞市康瑞电子有限公司

DongGuan Konnra Electronics CO., LTD

PART NO.: H25110\*\*\*0101A

VER.: A1 DRAWING NO.: 2511H101-A-S

A

B

C

E

F

A

B

C

E

F

1

2

3

4

5

6

7

8

9

1

2

3

4

5

6

7

8

9

**RoHS**  
COMPLIANT

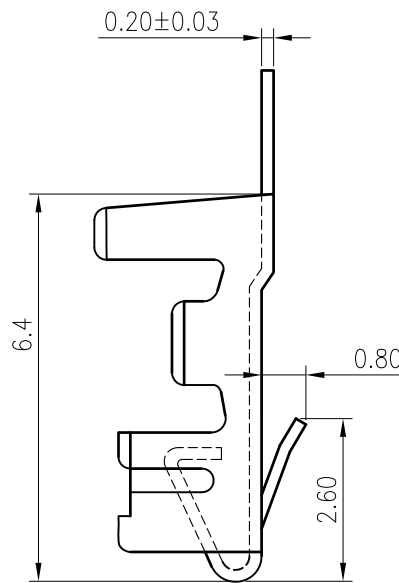
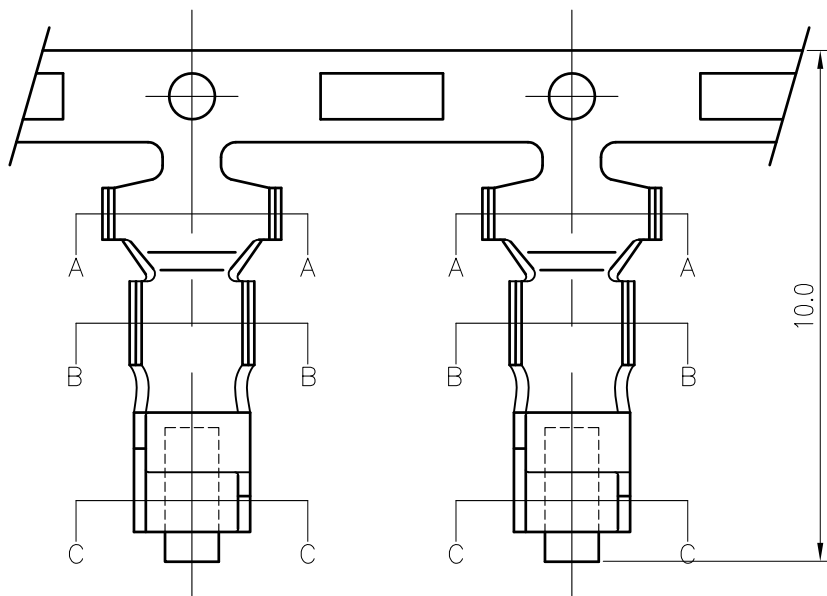

**SPECIFICATIONS**

1. Current rating: 3A AC, DC
2. Voltage rating: 250V AC, DC
3. Temperature range: -40°C ~ +105°C
4. Insulation resistance: 1000MΩ/ min.
5. Withstanding voltage: 1000V AC/ minute.
6. Contact resistance: 20mΩ/ max.

Material: Phosphor Bronze/Tin plated over nickel  
 Applicable wires: AWG #28~#22  
 Insulation O.D 1.2~1.6mm Max.  
 Suitable KR2501 or KR2502 series Housing  
 Qty/reel: 6,000PCS

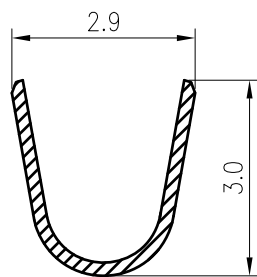

SECTION A-A

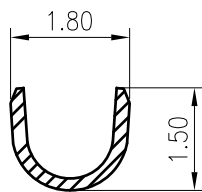

SECTION B-B

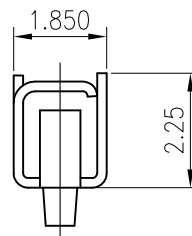

SECTION C-C

F					TOLERANCE	TITLE:	DRAWN: Shen 2022.01.13	KONNRA 东莞市康瑞电子有限公司 DongGuan Konnra Electronics CO.,LTD		
					X.X ±0.30	XH2.5 Terminal	CHECKED:			
		Uniformly arrange the drawings	Shen	2022.01.13	X.XX ±0.20		APPROVED:	PART NO.: T25010PT0102C		
MARK	REVISION DESCRIPTION	SIGNATURE	DATE	X.XXX ±0.10	UNIT:mm	SCALE:N/A	SHEET: 1/1	PROJECTION	VER.: A2	DRAWING NO.: 2501T01-C-S
	1	2	3	4	5	6	7	8	9	

**RoHS**  
COMPLIANT

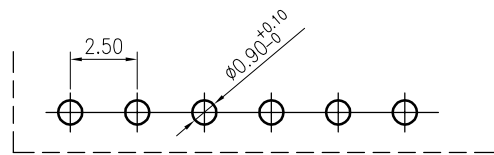
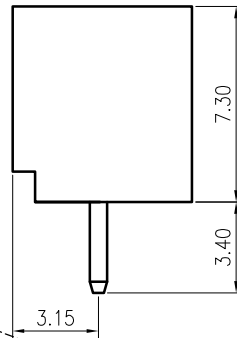
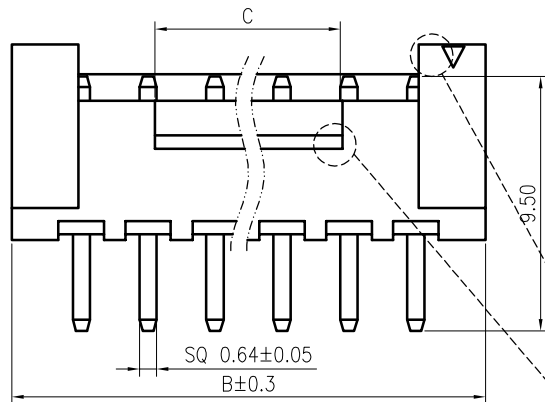
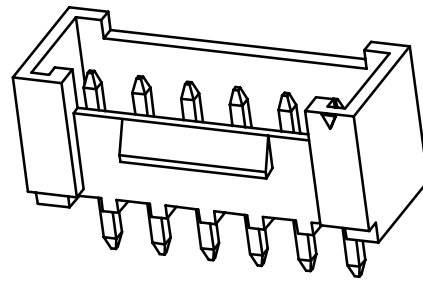
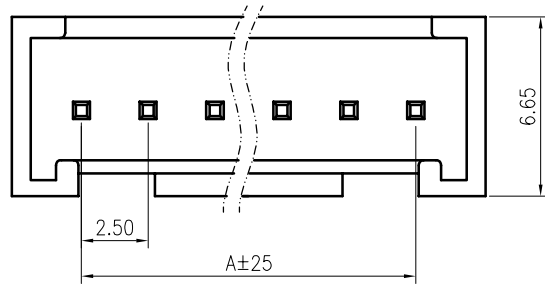

Recommended P.C.B. Layout  
Total tolerance: ±0.05mm

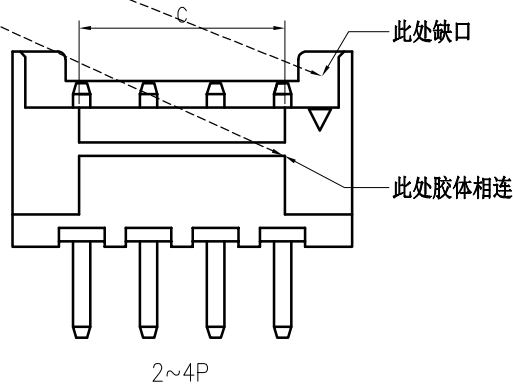

**SPECIFICATIONS**

1. Current rating: 3A AC, DC
2. Voltage rating: 250V AC, DC
3. Temperature range: -40°C ~ +105°C
4. Insulation resistance: 1000MΩ/ min.
5. Withstanding voltage: 1000V AC/ minute.
6. Contact resistance: 20mΩ/ max.

**Material:**

Insulator: PA66 UL94 V-0  
Contact: Brass  
Plating: Tin plated over Nickel  
Mate with KR2511 series housing

**Ordering Code:**

C2511VD \*\*\* 01 T01 02PA  
No. of Circuits } Plating  
102:02, 116:16 } T01: Tin plated  
Insulator Material }  
01: PA66 White V0

Circuits	Dimensions			Circuits	Dimensions		
	A	B	C		A	B	C
2	2.50	7.50	3.50	10	22.50	27.50	12.50
3	5.00	10.00	6.00	11	25.00	30.00	15.00
4	7.50	12.50	8.50	12	27.50	32.50	15.50
5	10.00	15.00	7.50	13	30.00	35.00	17.50
6	12.50	17.50	7.50	14	32.50	37.50	17.50
7	15.00	20.00	10.00	15	35.00	40.00	20.00
8	17.50	22.50	10.00	16	37.50	42.50	20.00
9	20.00	25.00	12.50				

F	△4				
	△3				
	△2				
	MARK	REVISION DESCRIPTION	SIGNATURE	DATE	

**TOLERANCE**  
X. X ±0.30  
X. XX ±0.20  
X. XXX ±0.10  
Angle ±2°

**TITLE:**  
XHQ2.5 DIP 180°  
Wafer No K  
UNIT: mm SCALE: N/A

**DRAWN:** Arvin 2021.03.13  
**CHECKED:**  
**APPROVED:**  
SHEET: 1/1 PROJECTION

**KONNRA** 东莞市康瑞电子有限公司  
DongGuan Konnra Electronics Co., Ltd.  
PART NO.: C2511VD\*\*\*01T0102PA  
REV.: A1 DRAWING NO.: 2511WDD102-A-S