

**RoHS**  
COMPLIANT

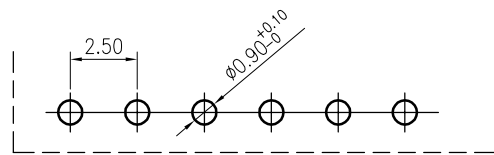

Recommended P.C.B. Layout  
Total tolerance: ±0.05mm

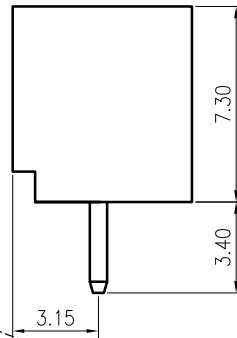
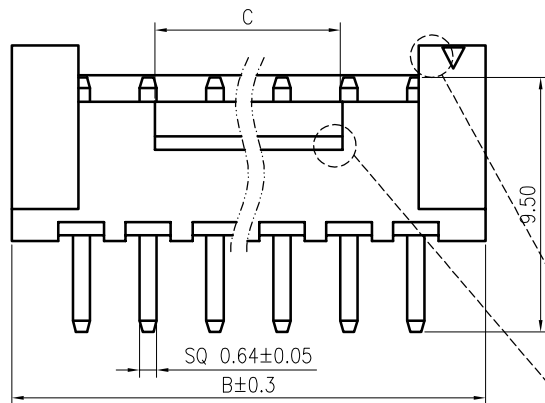
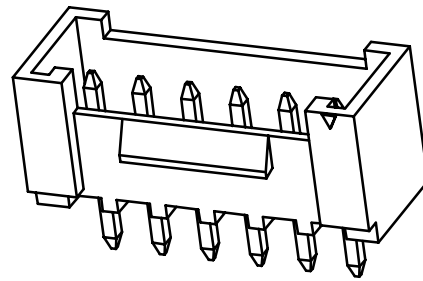
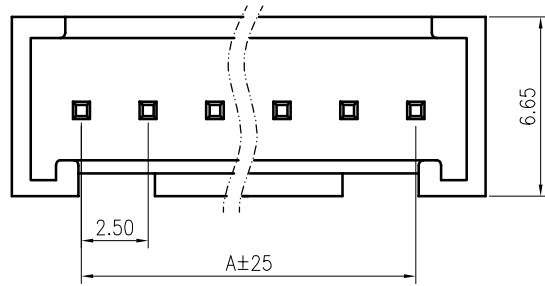
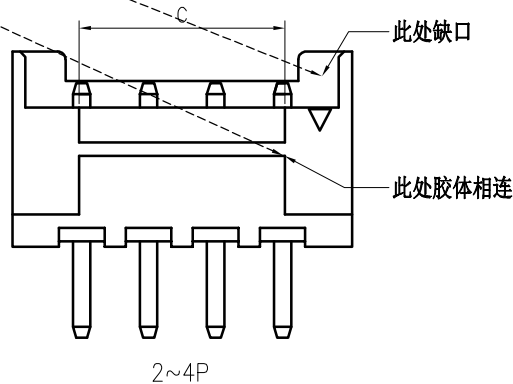

**SPECIFICATIONS**

1. Current rating: 3A AC, DC
2. Voltage rating: 250V AC, DC
3. Temperature range: -40°C ~ +105°C
4. Insulation resistance: 1000MΩ/ min.
5. Withstanding voltage: 1000V AC/ minute.
6. Contact resistance: 20mΩ/ max.

**Material:**

Insulator: PA66 UL94 V-0  
Contact: Brass  
Plating: Tin plated over Nickel  
Mate with KR2511 series housing

**Ordering Code:**

C2511VD \*\*\* 01 T01 02PA  
No. of Circuits } Plating  
102:02, 116:16 } T01: Tin plated  
Insulator Material }  
01: PA66 White V0

Circuits	Dimensions			Circuits	Dimensions		
	A	B	C		A	B	C
2	2.50	7.50	3.50	10	22.50	27.50	12.50
3	5.00	10.00	6.00	11	25.00	30.00	15.00
4	7.50	12.50	8.50	12	27.50	32.50	15.50
5	10.00	15.00	7.50	13	30.00	35.00	17.50
6	12.50	17.50	7.50	14	32.50	37.50	17.50
7	15.00	20.00	10.00	15	35.00	40.00	20.00
8	17.50	22.50	10.00	16	37.50	42.50	20.00
9	20.00	25.00	12.50				

F	△4				
	△3				
	△2				
	MARK	REVISION DESCRIPTION	SIGNATURE	DATE	

**TOLERANCE**  
X. X ±0.30  
X. XX ±0.20  
X. XXX ±0.10  
Angle ±2°

**TITLE:**  
XHQ2.5 DIP 180°  
Wafer No K

UNIT: mm SCALE: N/A

**DRAWN:** Arvin 2021.03.13

**CHECKED:**

**APPROVED:**

SHEET: 1/1 PROJECTION

**KONNRA** 东莞市康瑞电子有限公司  
DongGuan Konnra Electronics Co., Ltd.

PART NO.: C2511VD\*\*\*01T0102PA

REV.: A1 DRAWING NO.: 2511WD102-A-S