

**RoHS**  
COMPLIANT

**SPECIFICATIONS**

1. Current rating: 3A AC, DC
2. Voltage rating: 250V AC,DC
3. Temperature range: -40°C ~ +105°C
4. Insulation resistance: 1000MΩ Min.
5. Withstanding voltage: 1000V AC/ minute.
6. Contact resistance: 20mΩ Max.

**Material:**

Insulator: PA66 UL94 V-0  
 Contact: Brass  
 Plating: Tin plated over Nickel  
 Mate with KR2500 series Housing  
 Ordering Code:

C2500VD \*\*\* 22 T01 01 PB

No. of Circuits

102:2,116:16

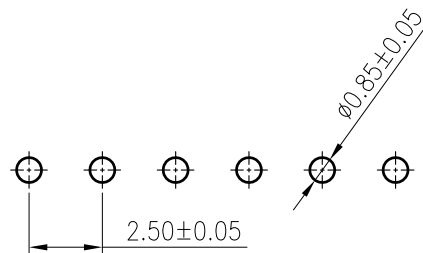
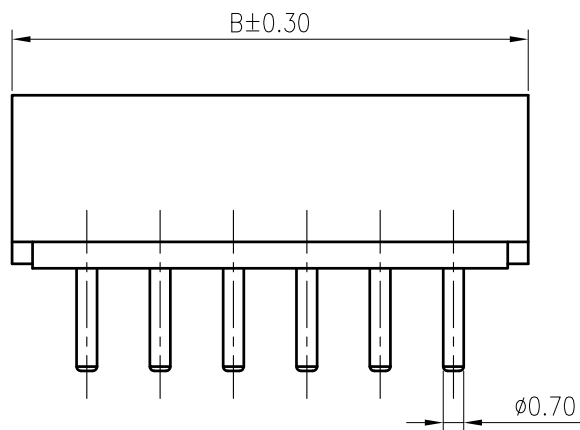
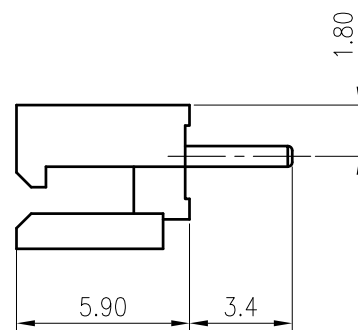
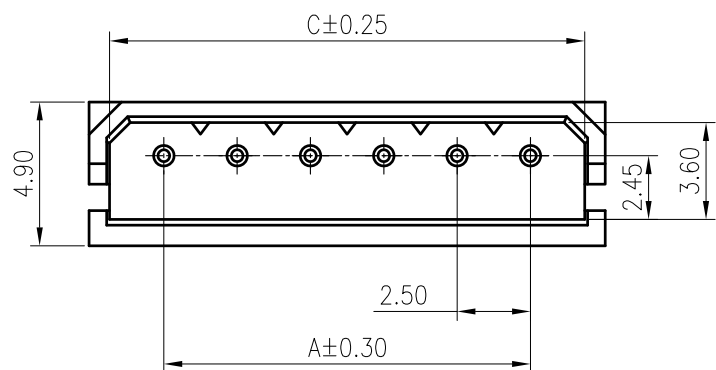

P.C.Board Layout

Circuits	Dimension		
	A	B	C
2	2.50	7.50	6.30
3	5.00	10.00	8.80
4	7.50	12.50	11.30
5	10.00	15.00	13.80
6	12.50	17.50	16.30
7	15.00	20.00	18.80
8	17.50	22.50	21.30
9	20.00	25.00	23.80
10	22.50	27.50	26.30
11	25.00	30.00	28.80
12	27.50	32.50	31.30
13	30.00	35.00	33.80
14	32.50	37.50	36.30
15	35.00	40.00	38.80
16	37.50	42.50	41.30

TOLERANCE  
 X.X ±0.30  
 X.XX ±0.20  
 X.XXX ±0.10  
 Angle ±2°

TITLE:  
 MX2.5 DIP 180°  
 Wafer

DRAWN: Shen 2022.01.08

CHECKED:

APPROVED:

**KONNRA** 东莞市康瑞电子有限公司  
 DongGuan Konnra Electronics Co.,Ltd.

PART NO.: C2500VD\*\*\*22T0101PB



Uniformly arrange the drawings

Shen 2022.01.08

MARK

REVISION DESCRIPTION

SIGNATURE

DATE

UNIT:mm SCALE:N/A

SHEET:1/1

PROJECTION

REV.:A3

DRAWING NO.:2500WVD101-B-S

1

2

3

4

5

6

7

8

9