

RoHS
COMPLIANT

SPECIFICATIONS

1. Current rating: 2A AC, DC
2. Voltage rating: 250V AC,DC
3. Temperature range: -40°C ~ +105°C
4. Insulation resistance: 1000M Ω Min.
5. Withstanding voltage: 800V AC/ minute.
6. Contact resistance: 20m Ω Max.

Material: Nylon 66 UL 94V-0
 Suitable KR2012 series terminal
 Mate with KR2012 series wafer
 Ordering Code:

H20120 *** 01 01C

No. of Circuits
 202:2*2,220:2*20
 Insulator Material
 01:PA66 White V0

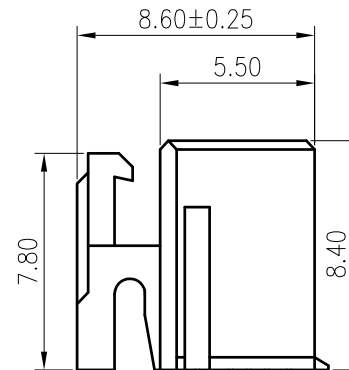
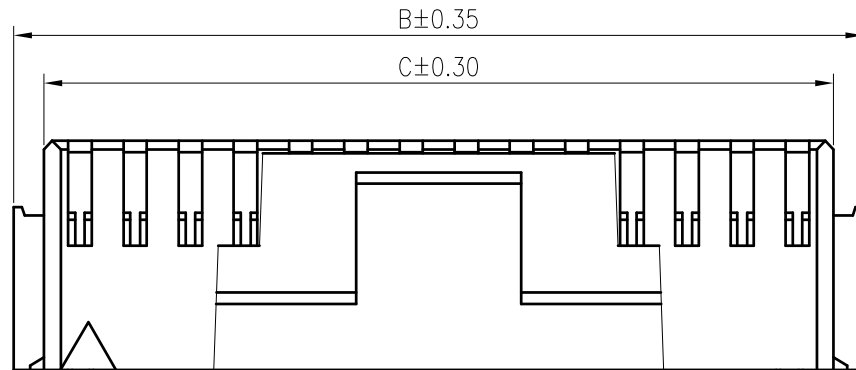
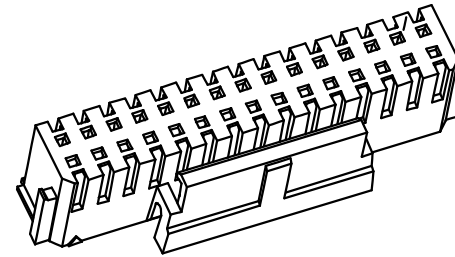
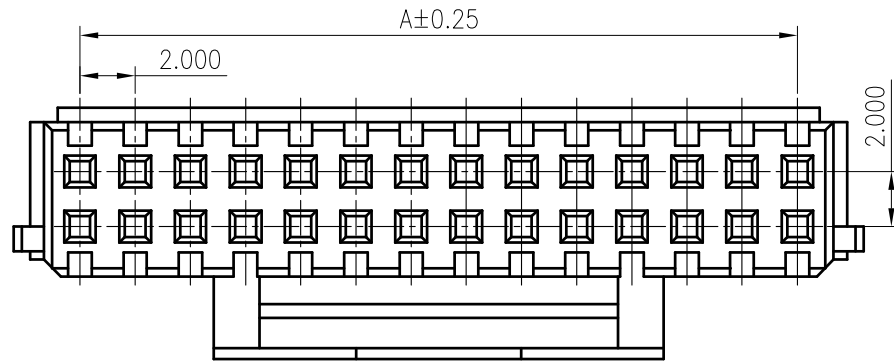

| Circuits | Dimensions | | | Circuits | Dimensions | | |
|----------|------------|-------|-------|----------|------------|-------|-------|
| | A | B | C | | A | B | C |
| 2x2 | 2.00 | 6.70 | 4.70 | 2x12 | 22.00 | 26.70 | 24.70 |
| 2x3 | 4.00 | 8.70 | 6.70 | 2x13 | 24.00 | 28.70 | 26.70 |
| 2x4 | 6.00 | 10.70 | 8.70 | 2x14 | 26.00 | 30.70 | 28.70 |
| 2x5 | 8.00 | 12.70 | 10.70 | 2x15 | 28.00 | 32.70 | 30.70 |
| 2x6 | 10.00 | 14.70 | 12.70 | 2x16 | 30.00 | 34.70 | 32.70 |
| 2x7 | 12.00 | 16.70 | 14.70 | 2x17 | 32.00 | 36.70 | 34.70 |
| 2x8 | 14.00 | 18.70 | 16.70 | 2x18 | 34.00 | 38.70 | 36.70 |
| 2x9 | 16.00 | 20.70 | 18.70 | 2x19 | 36.00 | 40.70 | 38.70 |
| 2x10 | 18.00 | 22.70 | 20.70 | 2x20 | 38.00 | 42.70 | 40.70 |
| 2x11 | 20.00 | 24.70 | 22.70 | | | | |

| | | | | | | | | | | |
|------|----------------------|-----------|------|---------------------|-----------------------|------------|------------------------|--|--|--|
| | | | | TOLERANCE | TITLE: PHB2.0 Housing | | DRAWN: Shen 2022.01.08 | | KONNRA 东莞市康瑞电子有限公司 DongGuan Konnra Electronics Co.,Ltd. | |
| | | | | X.X ± 0.30 | | | CHECKED: | | PART NO.: H20120***0101C | |
| | | | | X.XX ± 0.20 | | | APPROVED: | | | |
| | | | | X.XXX ± 0.10 | | | SHEET: 1/1 | | | |
| | | | | Angle $\pm 2^\circ$ | UNIT: mm | SCALE: N/A | PROJECTION | | DRAWING NO.: 2012H101-C-S | |
| MARK | REVISION DESCRIPTION | SIGNATURE | DATE | | | | | | | |

RoHS
COMPLIANT

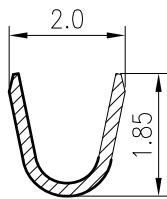
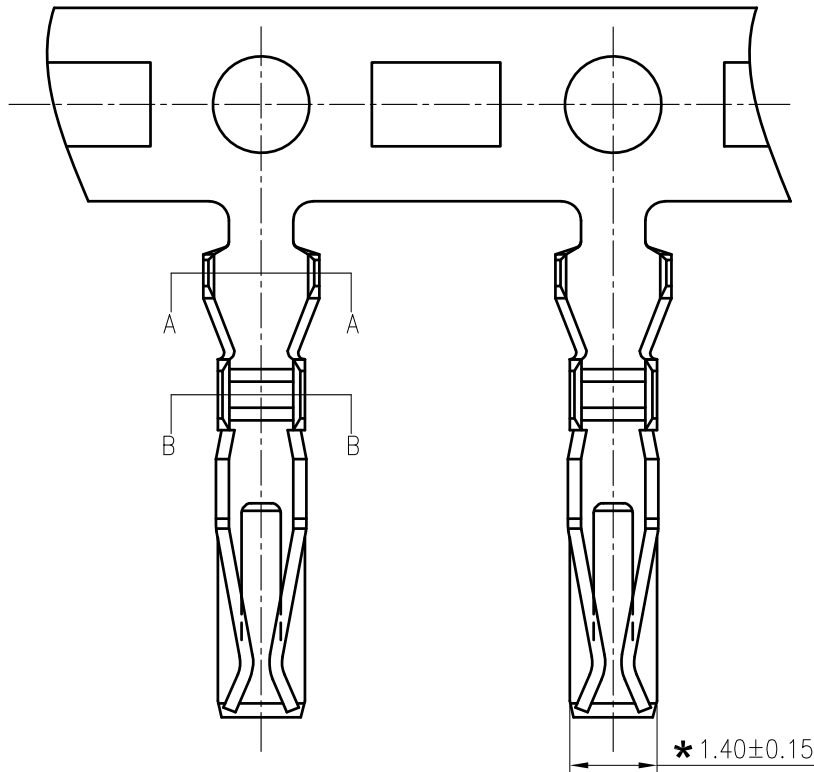

Section A-A

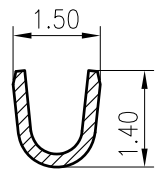

Section B-B

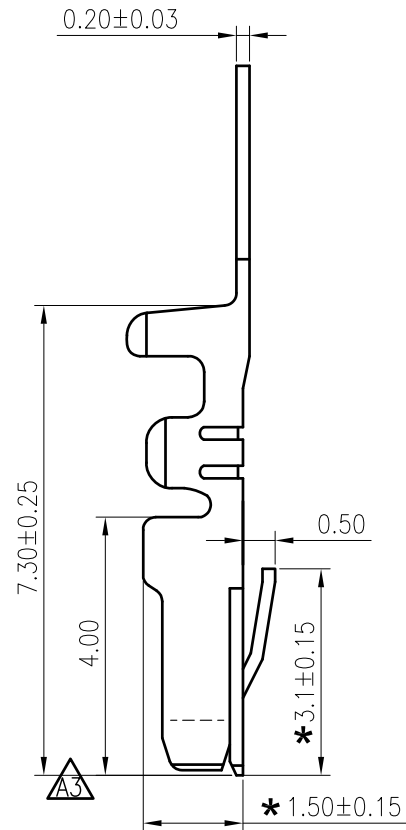

SPECIFICATIONS

1. Current rating: 2A AC, DC
2. Voltage rating: 250V AC,DC
3. Temperature range: -40°C ~ +105°C
4. Insulation resistance: 1000MΩ Min.
5. Withstanding voltage: 800V AC/ minute.
6. Contact resistance: 20mΩ Max.

Applicable Wires:

AWG#24-#28

Insulation O.D. : 1.60mm MAX

Material: Phosphor Bronze

Plating: Tin plated over nickel

Suitable KR2012 series housing

Q'ty/reel:15,000 PCS

TOLERANCE
X.X ±0.30
X.XX ±0.20
X.XXX ±0.10
Angle ±2°

TITLE:
PHB 2.0 Terminal

DRAWN: *Liujiangtian 2020.05.04*

CHECKED:

APPROVED:

UNIT:mm SCALE:N/A

SHEET:1/1

PROJECTION

KONNRA 东莞市康瑞电子有限公司
DongGuan Konnra Electronics Co.,Ltd.

PART NO.:T20120P***01C

REV.:A4 DRAWING NO.:2012T101-C-S



Uniformly arrange the drawings

Shen 2022.01.08

MARK

REVISION DESCRIPTION

SIGNATURE

DATE

1 2 3 4 5 6 7 8 9

RoHS
COMPLIANT

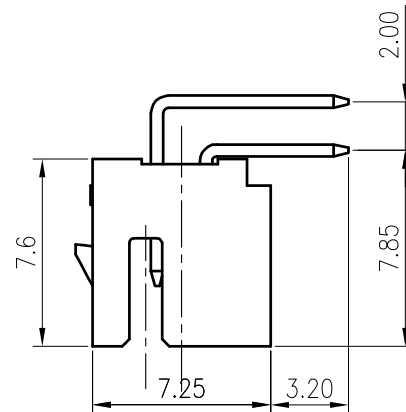
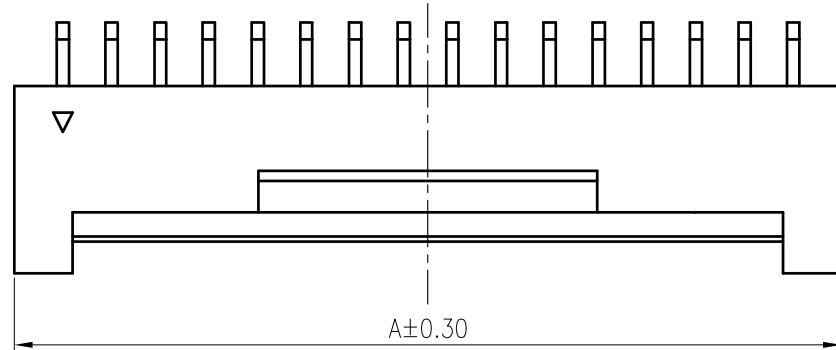

SPECIFICATIONS

1. Current rating: 2A AC, DC
2. Voltage rating: 250V AC, DC
3. Temperature range: -40°C ~ +105°C
4. Insulation resistance: 1000MΩ/ min.
5. Withstanding voltage: 800V AC/ minute.
6. Contact resistance: 30mΩ/ max.

Material:

Insulator: PA66 UL94 V-0
Contact: Brass
Plating: Tin plated or gold plated over Nickel
Mate with KR2012 series housing

Ordering Code:

C2012RD *** ** T01 01PC
 No. of Circuits ———— Plating
 202:2x2,20:2x20 ———— T01: Tin plated
 Insulator Material ———— G03: Gold plated 3u"
 22: PA66 Beige V0

| Circuits | Dimension | |
|----------|-----------|-------|
| | A | B |
| 2*2 | 6.00 | 2.00 |
| 2*3 | 8.00 | 4.00 |
| 2*4 | 10.00 | 6.00 |
| 2*5 | 12.00 | 8.00 |
| 2*6 | 14.00 | 10.00 |
| 2*7 | 16.00 | 12.00 |
| 2*8 | 18.00 | 14.00 |
| 2*9 | 20.00 | 16.00 |
| 2*10 | 22.00 | 18.00 |
| 2*11 | 24.00 | 20.00 |
| 2*12 | 26.00 | 22.00 |
| 2*13 | 28.00 | 24.00 |
| 2*14 | 30.00 | 26.00 |
| 2*15 | 32.00 | 28.00 |
| 2*16 | 34.00 | 30.00 |
| 2*17 | 36.00 | 32.00 |
| 2*18 | 38.00 | 34.00 |
| 2*19 | 40.00 | 36.00 |
| 2*20 | 42.00 | 38.00 |

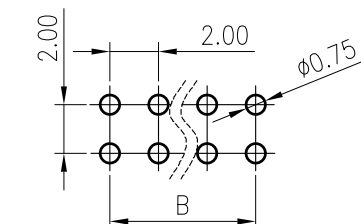
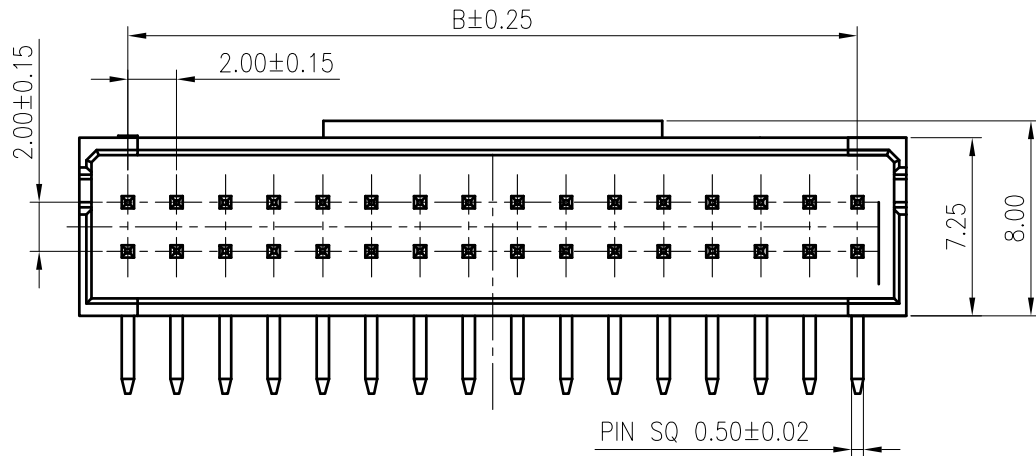

Recommended P.C.B. Layout
Total tolerance: ±0.05mm

| MARK | REVISION DESCRIPTION | SIGNATURE | DATE | TOLERANCE | TITLE: | DRAWN: | CHECKED: | APPROVED: | REV.: | DRAWING NO.: |
|------|--------------------------------|-----------|------------|-------------|-------------------------|-----------------|-----------|------------|-------|--|
| A4 | Add Dimensions | ZSZ | 2022.05.20 | X.X ±0.30 | PHB2.0 DIP 90° Wafer | Shen 2022.01.08 | | | A4 | KONNRA 东莞市康瑞电子有限公司 DongGuan Konnra Electronics Co.,Ltd. PART NO.: C2012RD***22***01PC DRAWING NO.: 2012WRD201-C-S |
| A3 | Uniformly arrange the drawings | Shen | 2022.01.08 | X.XX ±0.20 | | | | | | |
| | | | | X.XXX ±0.10 | | | | | | |
| | | | | Angle ±2° | UNIT:mm | SCALE:N/A | SHEET:1/1 | PROJECTION | | |

RoHS
COMPLIANT

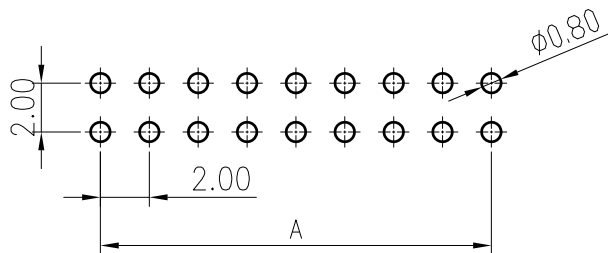
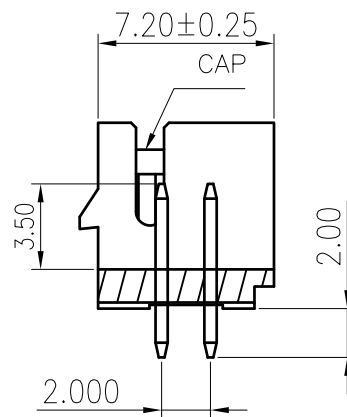
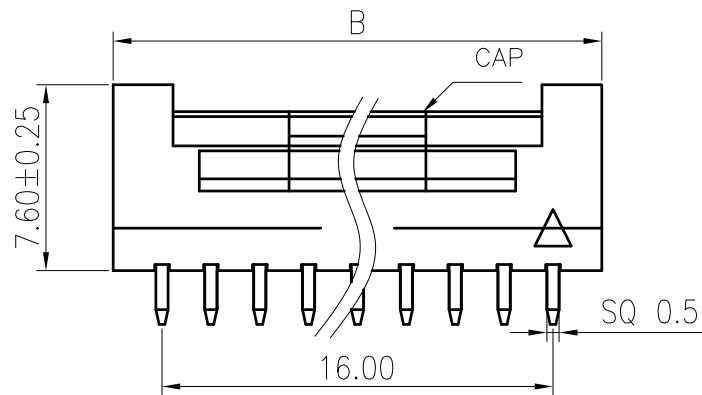
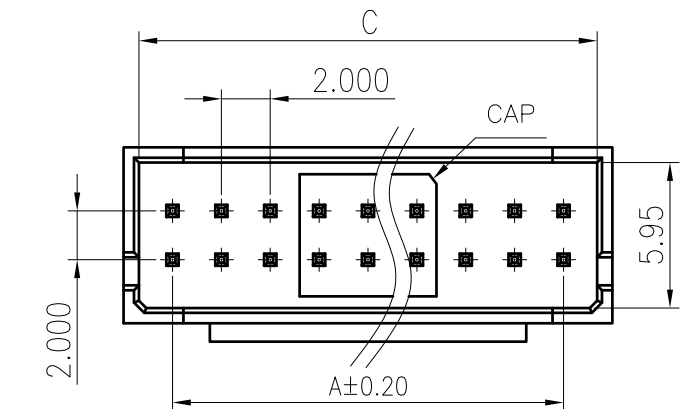

Recommended P.C.B. Layout
General tolerance: ±0.05mm

SPECIFICATIONS

1. Current rating: 2A AC, DC
2. Voltage rating: 250V AC,DC
3. Temperature range: -40°C ~ +105°C
4. Insulation resistance: 1000MΩ Min.
5. Withstanding voltage: 1000V AC/ minute.
6. Contact resistance: 30mΩ Max.

Material:

Insulator: LCP UL 94V-0

Contact: Brass

Plating: Tin plated over Nickel

Mate with KR2012 series Housing

Q'ty/reel: 350PCS

Ordering Code:

C2012VD*** 13 T01 01 RD

No.of Circuits

204:2*4,222:2*22

| Circuits | Dimensions | | |
|----------|------------|-------|--------|
| | A | B | C |
| 2x4 | 6.00 | 10.00 | 8.750 |
| 2x5 | 8.00 | 12.00 | 10.750 |
| 2x6 | 10.00 | 14.00 | 12.750 |
| 2x7 | 12.00 | 16.00 | 14.750 |
| 2x8 | 14.00 | 18.00 | 16.750 |
| 2x9 | 16.00 | 20.00 | 18.750 |
| 2x10 | 18.00 | 22.00 | 20.750 |
| 2x11 | 20.00 | 24.00 | 22.750 |
| 2x12 | 22.00 | 26.00 | 24.750 |
| 2x13 | 24.00 | 28.00 | 26.750 |

TOLERANCE

X.X ±0.20

X.XX ±0.10

X.XXX ±0.05

Angle ±2°

TITLE:
PHB2.0 DIP 180°
Wafer Short PIN
2.0

DRAWN: ZSZ 2022.11.01

CHECKED:

APPROVED:

KONNRA 东莞市康瑞电子有限公司

DongGuan Konnra Electronics Co.,Ltd.

PART NO.: C2012VD***13T0101RD

MARK REVISION DESCRIPTION SIGNATURE DATE UNIT:mm SCALE:N/A SHEET:1/1 PROJECTION REV.:A1 DRAWING NO.:2012WVD201-D-S

1 2 3 4 5 6 7 8 9

RoHS
COMPLIANT

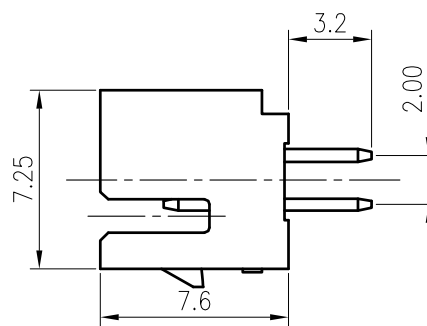
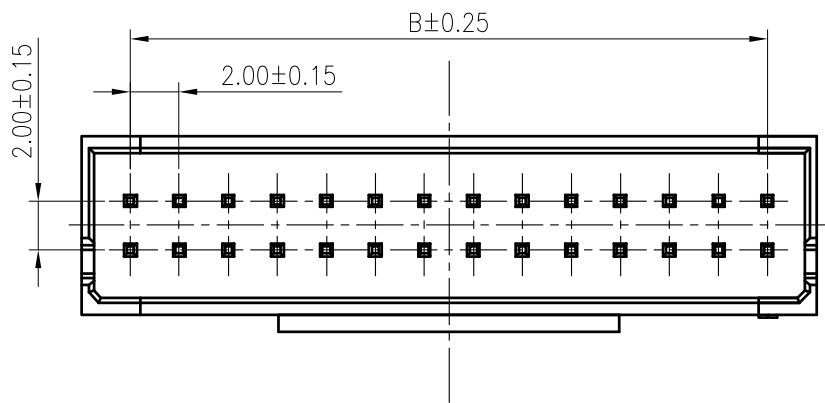

SPECIFICATIONS

1. Current rating: 2A AC, DC
2. Voltage rating: 250V AC, DC
3. Temperature range: -40°C ~ +105°C
4. Insulation resistance: 1000MΩ/ min.
5. Withstanding voltage: 800V AC/ minute.
6. Contact resistance: 30mΩ/ max.

Material:

Insulator: PA66 UL94 V-0
 Contact: Brass
 Plating: Tin plated or gold plated over Nickel
 Mate with KR2012 series housing

Ordering Code:

C2012VD *** ** T01 01PC
 No. of Circuits }
 202:2x2, 20:2x20 }
 Insulator Material }
 22:PA66 Beige V0 }
 Plating
 T01: Tin plated
 G03: Gold plated 3u"

| Circuits | Dimension | |
|----------|-----------|-------|
| | A | B |
| 2*2 | 6.00 | 2.00 |
| 2*3 | 8.00 | 4.00 |
| 2*4 | 10.00 | 6.00 |
| 2*5 | 12.00 | 8.00 |
| 2*6 | 14.00 | 10.00 |
| 2*7 | 16.00 | 12.00 |
| 2*8 | 18.00 | 14.00 |
| 2*9 | 20.00 | 16.00 |
| 2*10 | 22.00 | 18.00 |
| 2*11 | 24.00 | 20.00 |
| 2*12 | 26.00 | 22.00 |
| 2*13 | 28.00 | 24.00 |
| 2*14 | 30.00 | 26.00 |
| 2*15 | 32.00 | 28.00 |
| 2*16 | 34.00 | 30.00 |
| 2*17 | 36.00 | 32.00 |
| 2*18 | 38.00 | 34.00 |
| 2*19 | 40.00 | 36.00 |
| 2*20 | 42.00 | 38.00 |

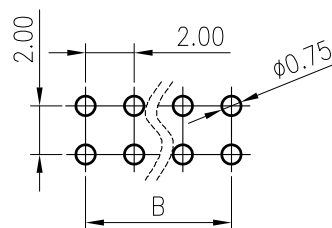
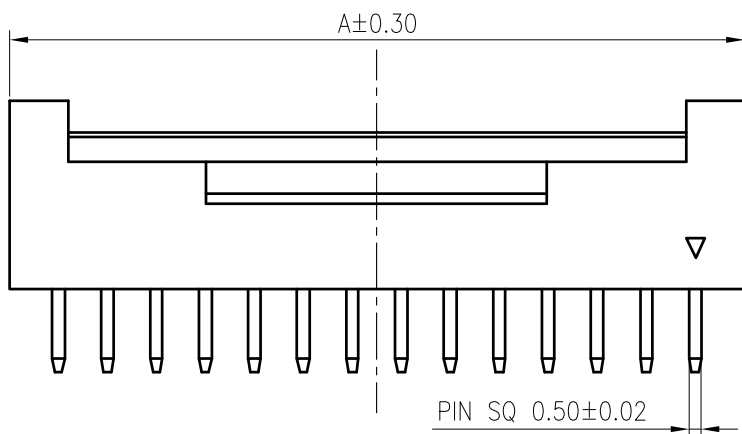

Recommended P.C.B. Layout
 Total tolerance: ±0.05mm

TOLERANCE
 X.X ±0.30
 X.XX ±0.20
 X.XXX ±0.10
 Angle ±2°

TITLE:
 PHB2.0 DIP 180°
 Wafer

DRAWN: Shen 2022.01.08

CHECKED:

APPROVED:

KONNRA 东莞市康瑞电子有限公司
 DongGuan Konnra Electronics Co., Ltd.

PART NO.: C2012VD***22***01PC

REV.: A3 DRAWING NO.: 2012WVD201-C-S

MARK REVISION DESCRIPTION SIGNATURE DATE

UNIT:mm SCALE:N/A SHEET:1/1 PROJECTION: REV.: A3 DRAWING NO.: 2012WVD201-C-S