

RoHS
COMPLIANT

SPECIFICATIONS

1. Current rating: 4A AC, DC
2. Voltage rating: 125V AC,DC
3. Temperature range: -40°C ~ +105°C
4. Insulation resistance: 1000MΩ Min.
5. Withstanding voltage: 1000V AC/ minute.
6. Contact resistance: 20mΩ Max.

Material:

Insulator: PA66 UL 94V-0

Contact: Brass

Plating: Tin plated over nickel

Mate with KR2008 series housing

Ordering Code:

C2008VD *** 01T0101PB

No.of Circuits
102:2,115:15

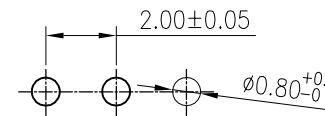
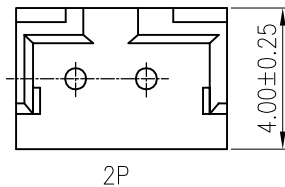
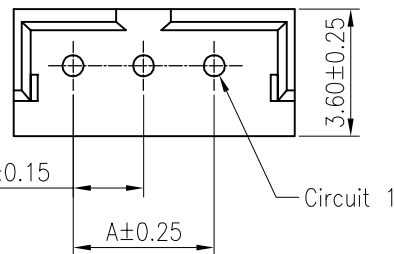
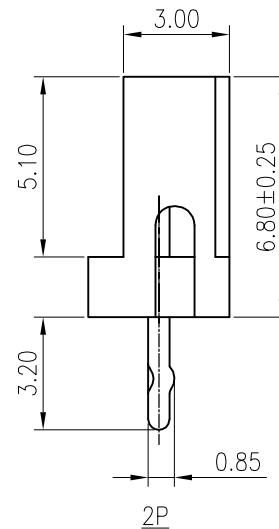
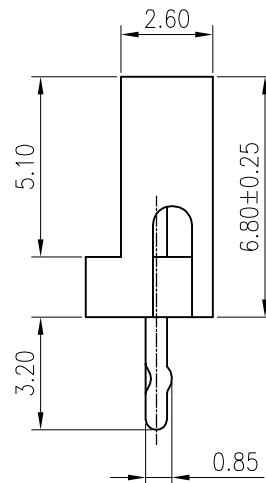
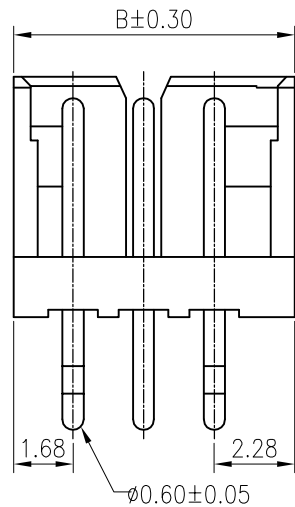

Recommended P.C.B. Layout
Total tolerance:±0.05mm

Circuits	Dimensions	
	A	B
2	2.00	5.96
3	4.00	7.96
4	6.00	9.96
5	8.00	11.96
6	10.00	13.96
7	12.00	15.96
8	14.00	17.96
9	16.00	19.96
10	18.00	21.96
11	20.00	23.96
12	22.00	25.96
13	24.00	27.96
14	26.00	29.96
15	28.00	31.96



MARK

1

2

3

4

5

6

7

8

9

TOLERANCE

- X. X ± 0.30
- X. XX ± 0.20
- X. XXX ± 0.10
- Angle ± 2°

TITLE:
AMP 2.0 DIP 180°
Wafer

DRAWN: ZSZ 2021.09.09

CHECKED:

APPROVED:

UNIT: mm SCALE: 1/1

SHEET: 1/1

PROJECTION

KONNRA 东莞市康瑞电子有限公司
DongGuan Konnra Electronics Co., Ltd.

PART NO. : C2008VD***01T0101PB

REV. : A3 DRAWING NO. : 2008WDD101-B-S