

RoHS
COMPLIANT

SPECIFICATIONS

1. Current rating: 2A AC, DC
2. Voltage rating: 100V AC, DC
3. Temperature range: -40°C ~ +105°C
4. Insulation resistance: 1000MΩ/ min.
5. Withstanding voltage: 800V AC/ minute.
6. Contact resistance: 20mΩ/ max.

Material:

Insulator: PA66 UL 94V-0
Contact: Brass
Plating: Tin plated over Nickel
Mate with KR2001 series Housing

Ordering Code:

C2002VD *** 17 T01 01PA
No. of Circuits | Plating
102:02, 116:16 | T01: Tin plated
Insulator Material
17: PA66 Brown V0

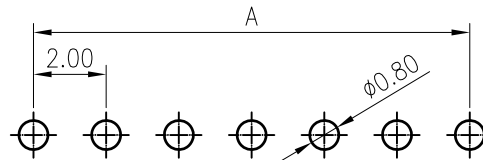
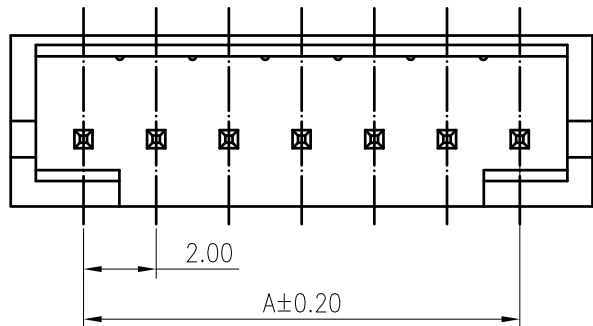
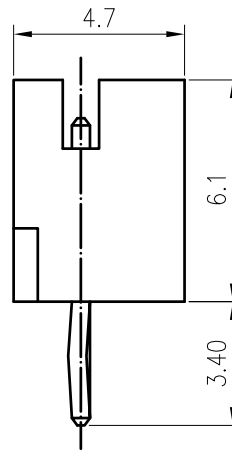
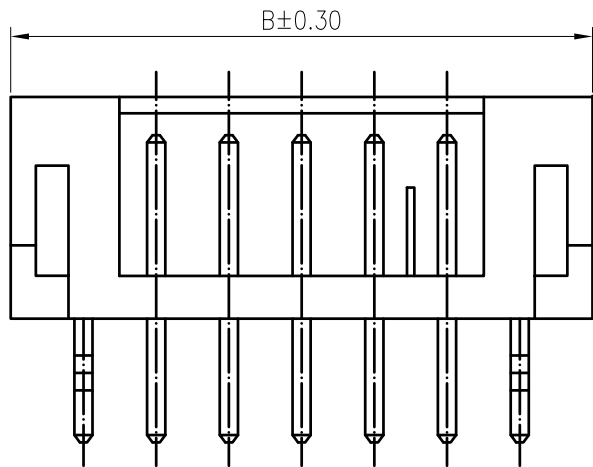

Recommended P.C.B. Layout
Total tolerance: $\pm 0.05\text{mm}$

Circuits	Dimensions		Circuits	Dimensions	
	A	B		A	B
2	2.00	6.00	10	18.00	22.00
3	4.00	8.00	11	20.00	24.00
4	6.00	10.00	12	22.00	26.00
5	8.00	12.00	13	24.00	28.00
6	10.00	14.00	14	26.00	30.00
7	12.00	16.00	15	28.00	32.00
8	14.00	18.00	16	30.00	34.00
9	16.00	20.00			

MARK	REVISION DESCRIPTION	SIGNATURE	DATE	TOLERANCE	TITLE:	DRAWN:	CHECKED:	APPROVED:	VER.:	DRAWING NO.:
A3	Uniformly arrange the drawings	ZSZ	2021.09.08	X.X ± 0.30	JAE2.0 DIP 180° Wafer	ZSZ 2021.09.08			A3	2002WVD101-A-S
A2	Change the part number and frame format	Arvin	2020.05.04	X.XX ± 0.20						
				X.XXX ± 0.10						
				Angle $\pm 2^\circ$	UNIT: mm	SCALE: N/A	SHEET: 1/1	PROJECTION		

KONNRA 东莞市康瑞电子有限公司
DongGuan Konnra Electronics Co., Ltd.

PART NO.: C2002VD***17T0101PA

VER.: A3 DRAWING NO.: 2002WVD101-A-S