

**RoHS**  
COMPLIANT

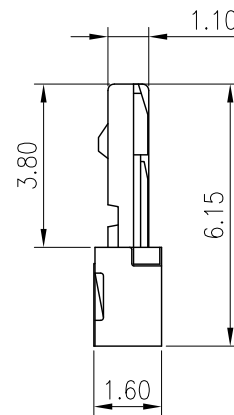
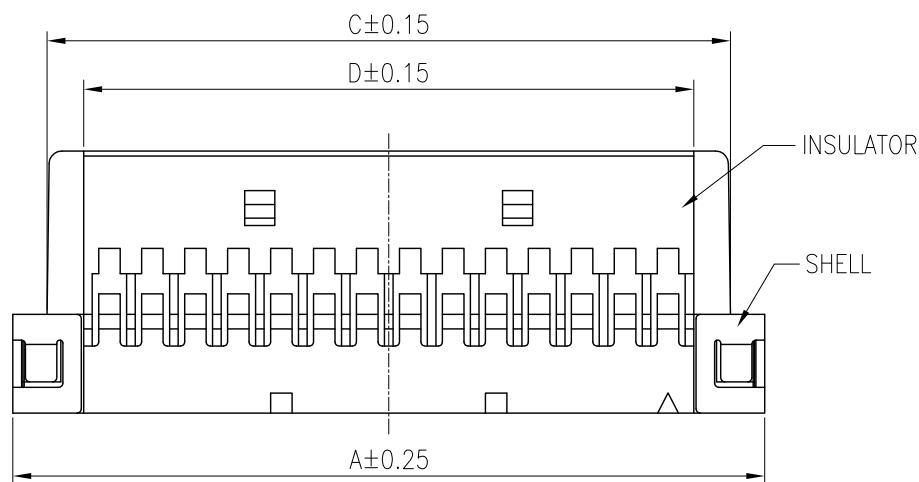
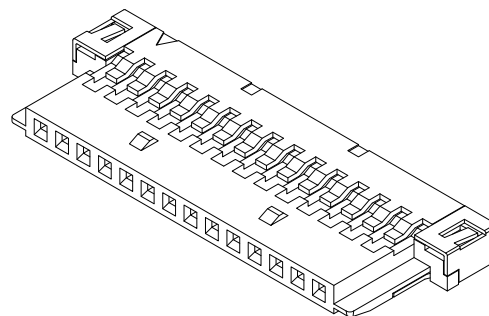
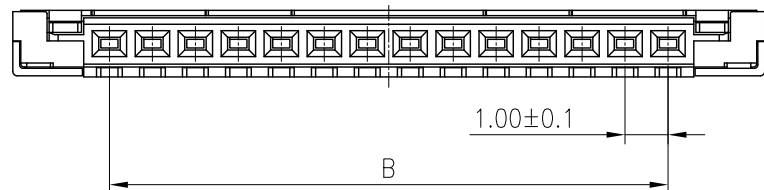

**SPECIFICATIONS**

1. Current rating: 1A AC, DC
2. Voltage rating: 100V AC, DC
3. Temperature range: -40°C ~ +105°C
4. Insulation resistance: 500MΩ/ min.
5. Withstanding voltage: 500V AC/ minute.
6. Contact resistance: 30mΩ/ max.

**Material:**

Insulator: PA66 UL 94V-0  
Shell: Stainless Steel  
Circuits: 08, 14, 20, 30  
Suitable KR1002 series terminal

**Ordering Code:**

H10020 120 22 01A

No. of Circuits ———  
120:20, 120:30  
Insulator Material ———  
22: PA66 Beige

Circuits	Dimensions			
	A	B	C	D
8	11.50	7.00	9.90	8.44
14	17.50	13.00	15.90	14.44
20	23.50	19.00	21.90	20.44
30	33.50	29.00	31.90	30.44

F	A4			TOLERANCE	TITLE:	DRAWN:	<b>KONNRA</b> 东莞市康瑞电子有限公司 DongGuan Konnra Electronics Co., Ltd. PART NO.: H10020***2201A
	A3	Uniformly arrange the drawings	Shen	2021.08.25	X.X ±0.30	CHECKED:	
	A2	Change the part number and frame format	Arvin	2020.04.15	X.XX ±0.20	APPROVED:	
	MARK	REVISION DESCRIPTION	SIGNATURE	DATE	X.XXX ±0.10	UNIT:mm	
	1	2	3	4	5	6	7
				Angle ±2°	SCALE: 1/1	PROJECTION	REV.: A2
							DRAWING NO.: 1002H101-A-S
	1	2	3	4	5	6	9

**RoHS**  
COMPLIANT

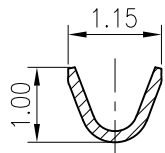
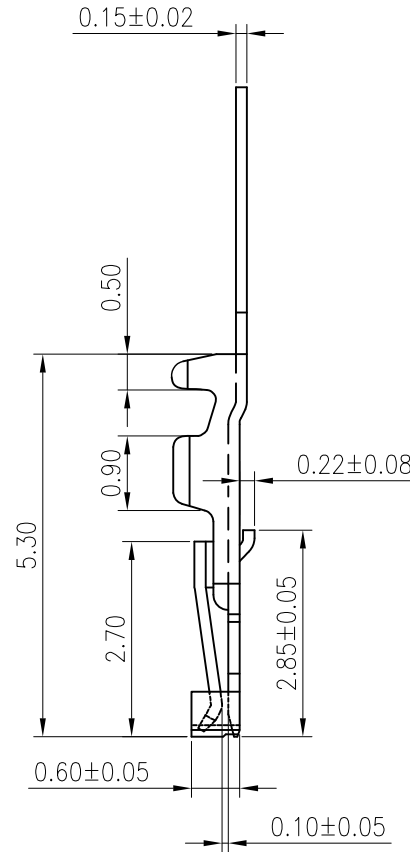
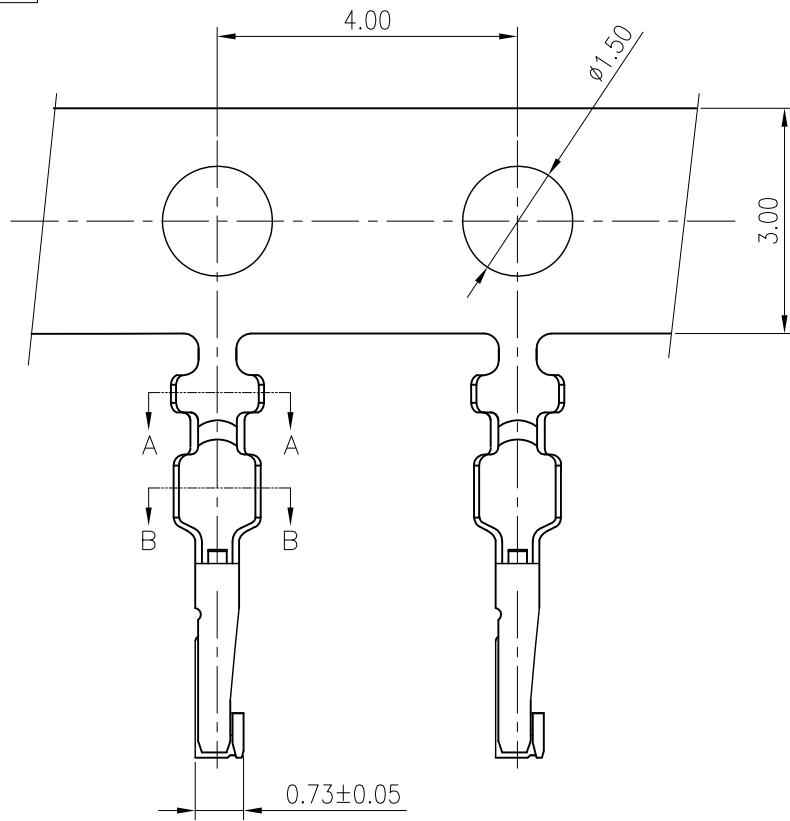

SECTION A-A

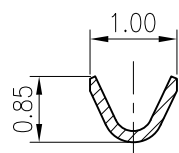

SECTION B-B

**SPECIFICATIONS**

1. Current rating: 1A AC, DC
2. Voltage rating: 100V AC, DC
3. Temperature range: -40°C ~ +105°C
4. Insulation resistance: 500MΩ/ min.
5. Withstanding voltage: 500V AC/ minute.
6. Contact resistance: 30mΩ/ max.

Material: Phosphor Bronze

Applicable wire:

AWG#28~#32

Insulation O.D. 0.80mm Max.

Plating: Gold plated over Nickel

Suitable KR1002 series Housing

Q'ty/Reel: 20,000 PCS



Uniformly arrange the drawings

Shen

2021.08.25



Change the part number and frame format

Arvin

2020.04.15



MARK

REVISION DESCRIPTION

SIGNATURE

DATE

TOLERANCE  
X.X ±0.30  
X.XX ±0.20  
X.XXX ±0.10  
Angle ±2°

TITLE:  
DF19 Terminal

UNIT:mm

SCALE: 1/1

DRAWN: Arvin 2021.08.25

CHECKED: Shen 2021.08.25

APPROVED:

SHEET: 1/1

PROJECTION

**KONNRA** 东莞市康瑞电子有限公司  
DongGuan Konnra Electronics Co.,Ltd.

PART NO.: T10020PG0101A

REV.: A2

DRAWING NO.: 1002T101-A-S

**RoHS**  
COMPLIANT

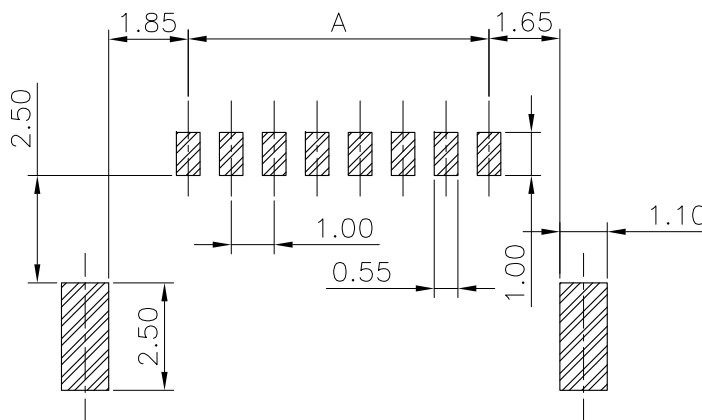
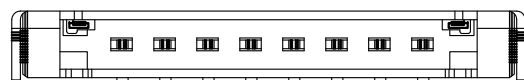
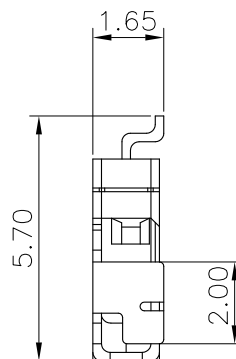
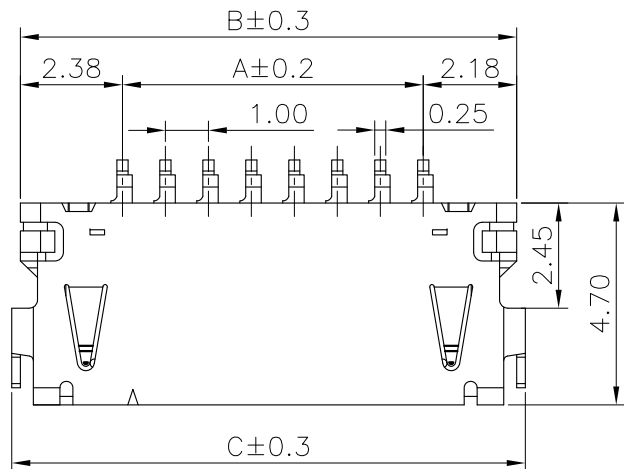

Recommended P.C.B Layout

**SPECIFICATIONS**

1. Current rating: 1A AC, DC
2. Voltage rating: 100V AC, DC
3. Temperature range: -40°C ~ +105°C
4. Insulation resistance: 500MΩ/ min.
5. Withstanding voltage: 500V AC/ minute.
6. Contact resistance: 30mΩ/ max.

**Material:**

Insulator: Nylon 6T UL 94V-0  
Contact: Phosphor Bronze  
Shell: Phosphor Bronze

**Plating:**

Contact: Gold flash  
Shell: Tin plated over Nickel

Circuits: 8, 14, 20, 30

Mate with KR1002 series housing

**Ordering Code:**

C1002RS 120 09 G01 01RA  
No. of Circuits | Plating  
120:20, 120:30 | G01: Gold flash  
Insulator Material  
09: PA6T Natural

Circuits	Dimensions		
	A	B	C
8	7.00	11.55	11.95
14	13.00	17.55	17.95
20	19.00	23.55	23.95
30	29.00	33.55	33.95

F	MARK	REVISION DESCRIPTION	SIGNATURE	DATE	TOLERANCE	TITLE:	DRAWN:	KONNRA 东莞市康瑞电子有限公司 DongGuan Konnra Electronics Co., Ltd.			
		1	Shen	2021.08.23	X.X ±0.30	DF19 SMT 90°	Arvin 2021.08.23				
		2	Arvin	2020.04.16	X.XX ±0.20	Wafer	Shen 2021.08.23				
		3			X.XXX ±0.10						
					Angle ±2°	UNIT:mm	SCALE:1/1	SHEET:1/1	PROJECTION	REV.:A3	DRAWING NO.:1002WRS101-A-S