

RoHS
COMPLIANT

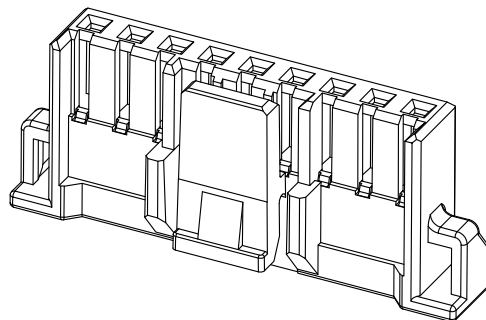
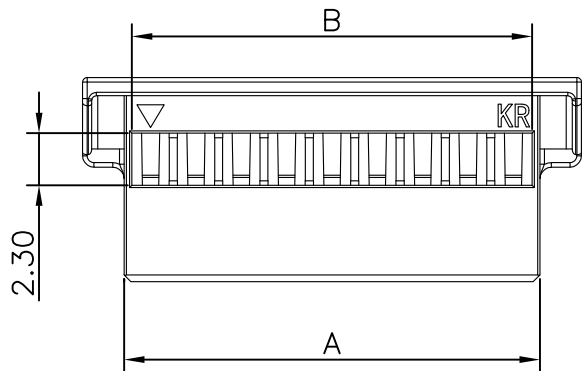

SPECIFICATIONS

1. Current rating: 3.0A AC, DC
2. Voltage rating: 250V AC,DC
3. Temperature range: -40°C ~ +105°C
4. Insulation resistance: 1000MΩ/ min.
5. Withstanding voltage: 500V AC/ minute.

Material: Plastic(PA66)
Suitable:
KR2022 series terminal(22AWG~24AWG)
Mated with KR2022 series Wafer

Ordering Code: H202201** ** 01A

102=1*2P 01:PA66 WHITE
103=1*3P
....

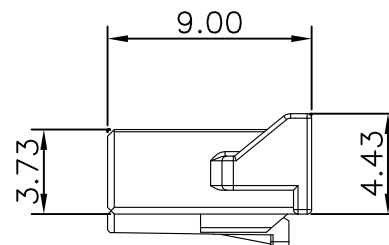
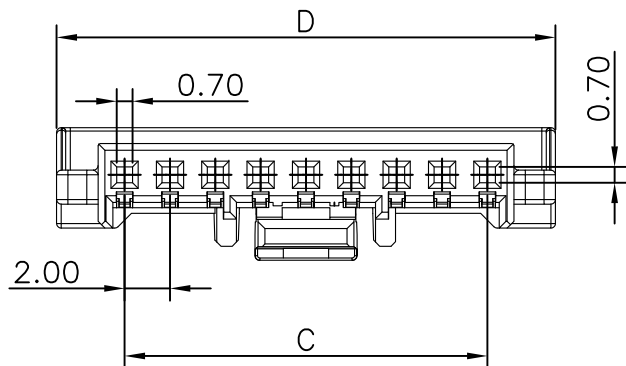

Cav NO

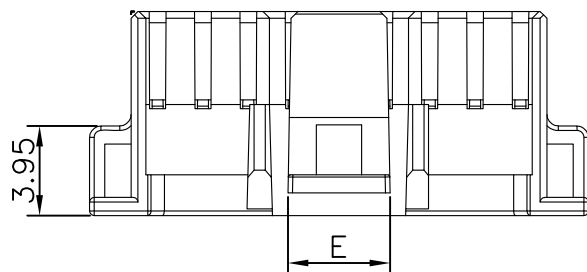
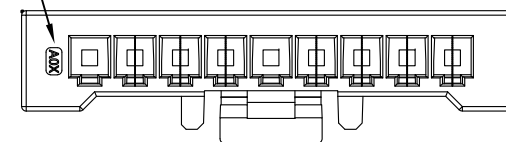

PIN.	Dimension				
	A	B	C	D	E
2P	4.34	3.65	2.00	8.0	2.60
3P	6.34	5.65	4.00	10.0	3.60
4P	8.34	7.65	6.00	12.0	4.50
5P	10.34	9.65	8.00	14.0	
6P	12.34	11.65	10.00	16.0	
7P	14.34	13.65	12.00	18.0	
8P	16.34	15.65	14.00	20.0	
9P	18.34	17.65	16.00	22.0	11.10
10P	20.34	19.65	18.00	24.0	
11P	22.34	21.65	20.00	26.0	
12P	24.34	23.65	22.00	28.0	
13P	26.34	25.65	24.00	30.0	
14P	28.34	27.65	26.00	32.0	
15P	30.34	29.65	28.00	34.0	

TOLERANCE
X.X ±0.30
X.XX ±0.20
X.XXX ±0.10
Angle ±2°

TITLE:
PAL2.0 Housing

DRAWN: XYH 2023.04.06

CHECKED:

APPROVED:

KONNRA 东莞市康瑞电子有限公司
DongGuan Konnra Electronics Co.,Ltd.

PART NO.: H202201** ** 01A



NEW DWG

XYH

2023.04.06

MARK

REVISION DESCRIPTION

SIGNATURE

DATE

UNIT:mm

SCALE:1:1

SHEET:1/3

PROJECTION



REV.:A1

DRAWING NO.:2022H101-A-S

RoHS
COMPLIANT

2P View

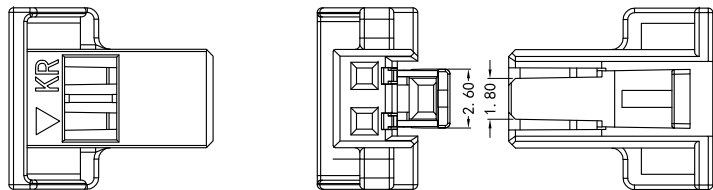

3P View

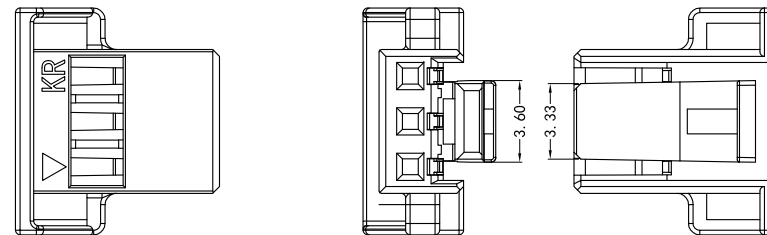

4P View

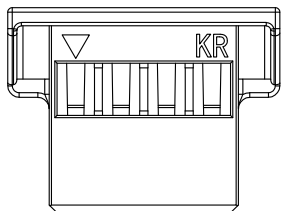

5P View

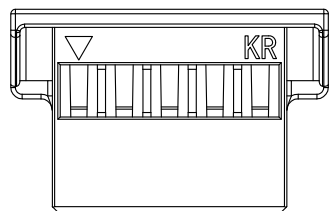

6P View

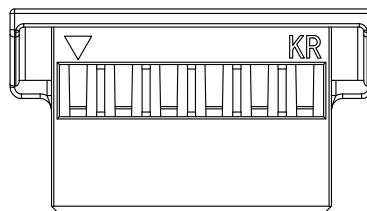

7P View

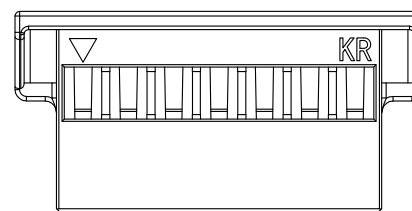

8P View

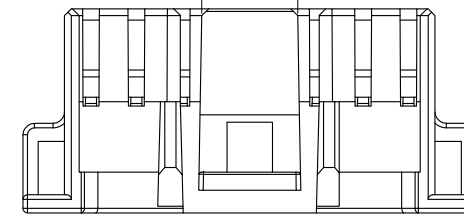
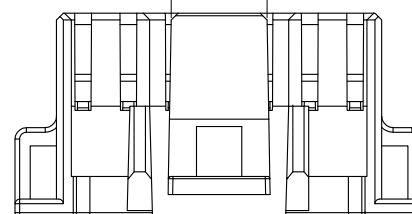
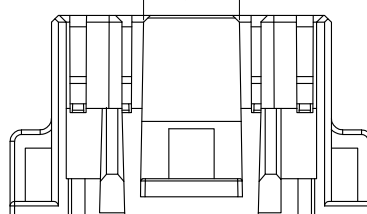
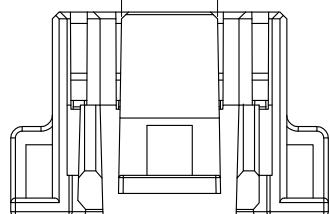
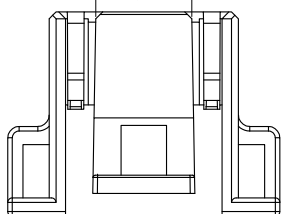
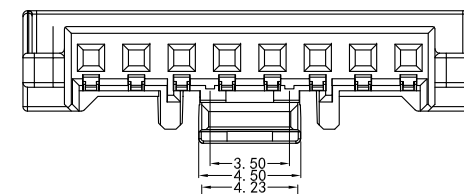
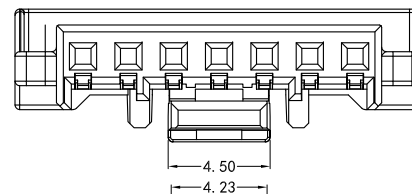
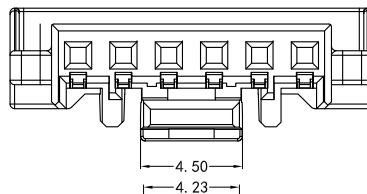
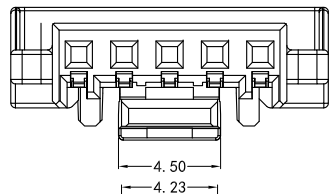
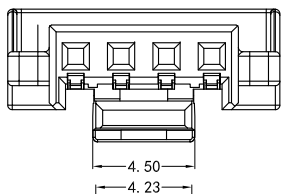
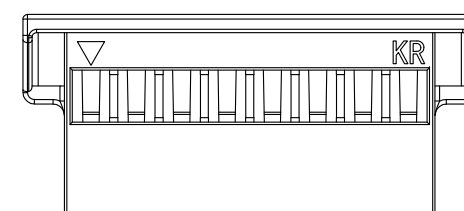

TOLERANCE
X.X ±0.10
X.XX ±0.05
X.XXX ±0.02
Angle ±2°

TITLE:
PAL2.0 Housing

DRAWN: *XYH* 2023.04.06

CHECKED:

APPROVED:

KONNRA 东莞市康瑞电子有限公司
DongGuan Konnra Electronics Co.,Ltd.

PART NO.: H202201** ** 01A



NEW DWG

XYH

2023.04.06

UNIT:mm

SCALE:1:1

SHEET:2/3

PROJECTION



REV.:A1

DRAWING NO.:2022H101-A-S

1

2

3

4

5

6

7

8

9

RoHS
COMPLIANT

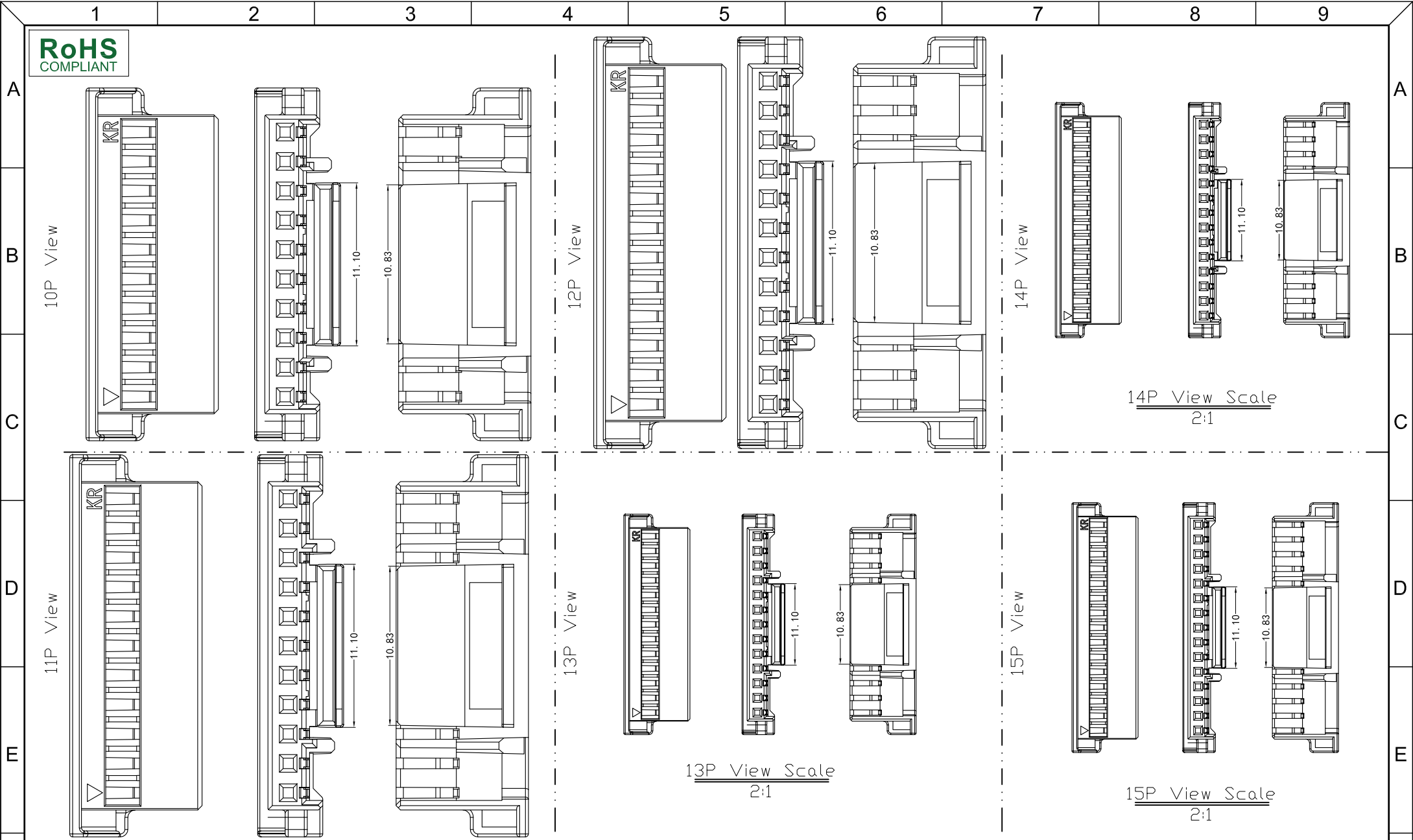

				TOLERANCE	TITLE:		DRAWN: <i>XYH</i> 2023.04.06		KONNRA 东莞市康瑞电子有限公司 DongGuan Konnra Electronics Co.,Ltd.										
				X.X ±0.10	PAL2.0 Housing		CHECKED:		PART NO.: H202201** ** 01A										
				X.XX ±0.05	UNIT: mm		APPROVED:		REV.: A1										
				X.XXX ±0.02	SCALE: 1:1		SHEET: 3/3		DRAWING NO.: 2022H101-A-S										
				Angle ±2°			PROJECTION												
<table border="1"> <tr> <td>MARK</td> <td>REVISION DESCRIPTION</td> <td>SIGNATURE</td> <td>DATE</td> </tr> <tr> <td>△1</td> <td>NEW DWG</td> <td>XYH</td> <td>2023.04.06</td> </tr> </table>				MARK	REVISION DESCRIPTION	SIGNATURE	DATE	△1	NEW DWG	XYH	2023.04.06								
MARK	REVISION DESCRIPTION	SIGNATURE	DATE																
△1	NEW DWG	XYH	2023.04.06																

RoHS
COMPLIANT

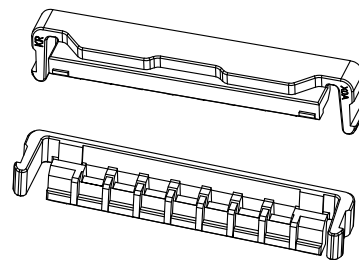
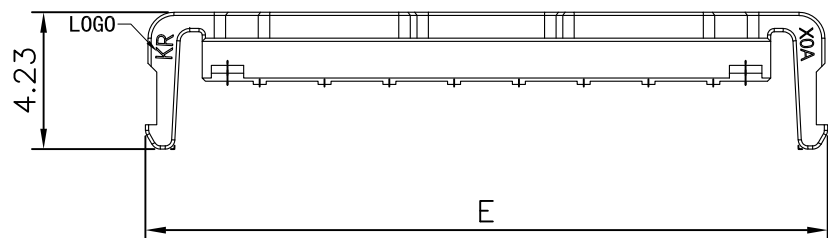
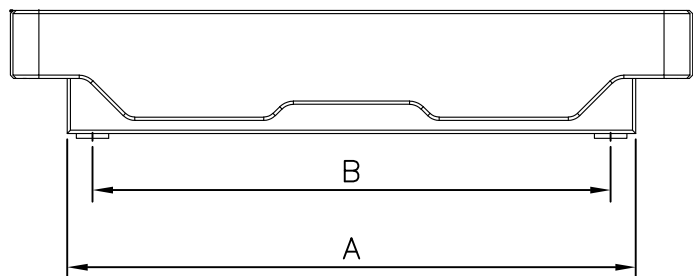
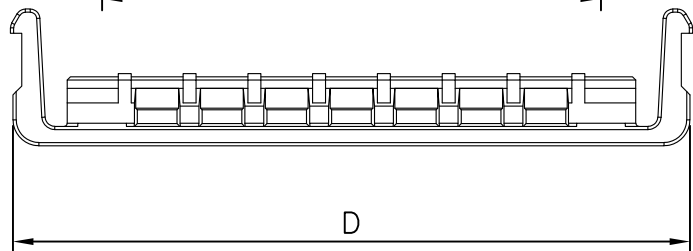
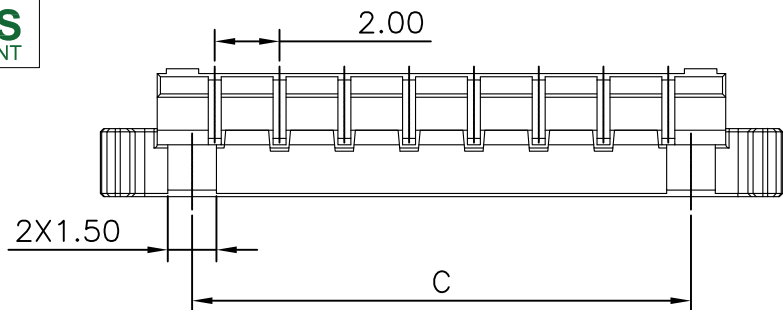

View Scale
2:1

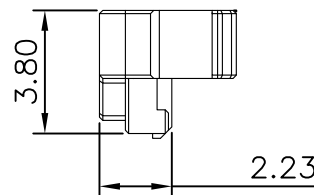

SPECIFICATIONS

1. Current rating: 3.0A AC, DC
2. Voltage rating: 250V AC,DC
3. Temperature range: -40°C ~ +105°C
4. Insulation resistance: 1000MΩ/ min.
5. Withstanding voltage: 500V AC/ minute.

Material: Plastic(PBT)

Suitable:

KR2022 series terminal(22AWG~24AWG)

Mated with KR2022 series Wafer

Ordering Code: H202201** ** 11A

102=1*2P 24:PBT WHITE
103=1*3P
....

PIN.	Dimension				
	A	B	C	D	E
2P	3.55	2.0	1.4	6.90	7.06
3P	5.55	4.0	3.4	8.90	9.06
4P	7.55	6.0	5.4	10.90	11.06
5P	9.55	8.0	7.4	12.90	13.06
6P	11.55	10.0	9.4	14.90	15.06
7P	13.55	12.0	11.4	16.90	17.06
8P	15.55	14.0	13.4	18.90	19.06
9P	17.55	16.0	15.4	20.90	21.06
10P	19.55	18.0	17.4	22.90	23.06
11P	21.55	20.0	19.4	24.90	25.06
12P	23.55	22.0	21.4	26.90	27.06
13P	25.55	24.0	23.4	28.90	29.06
14P	27.55	26.0	25.4	30.90	31.06
15P	29.55	28.0	27.4	32.90	33.06

TOLERANCE

X.X ±0.30
X.XX ±0.20
X.XXX ±0.10
Angle ±2°

TITLE:

PAL2.0 LOCK

DRAWN: *XYH* 2023.04.06

CHECKED:

APPROVED:

KONNRA 东莞市康瑞电子有限公司
DongGuan Konnra Electronics Co.,Ltd.

PART NO.:H202201**2411A



NEW DWG

XYH

2023.04.06

MARK

REVISION DESCRIPTION

SIGNATURE

DATE

UNIT:mm

SCALE:1:1

SHEET:1/2

PROJECTION



REV.:A1

DRAWING NO.:2022H111-A-S

RoHS
COMPLIANT

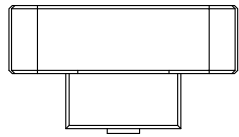

2P

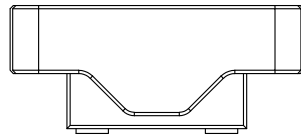

3P

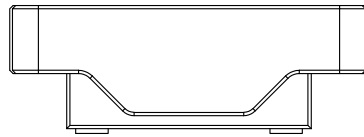

4P

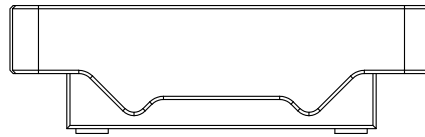

5P

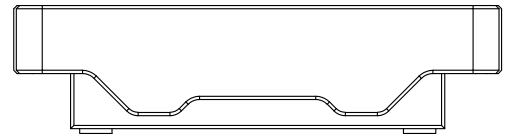

6P

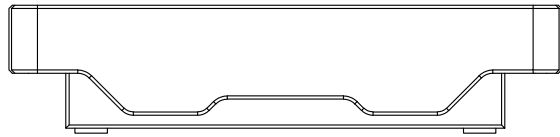

7P

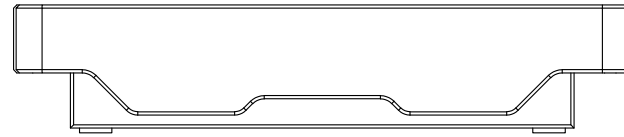

8P

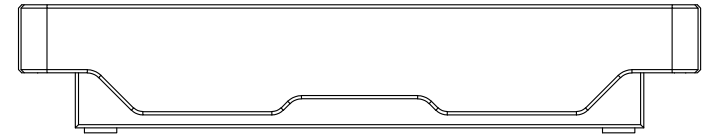

9P

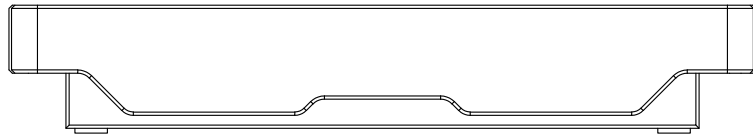

10P

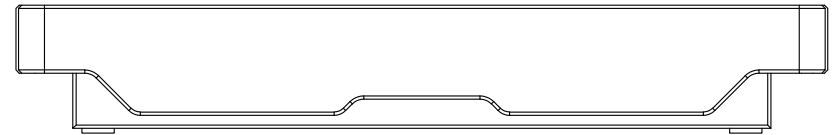

11P

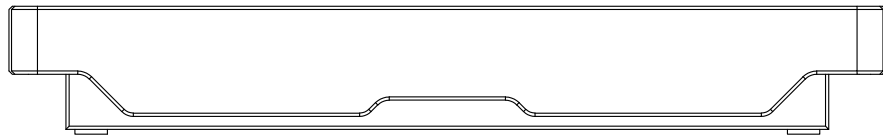

12P

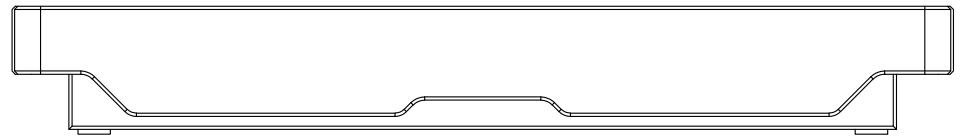

13P

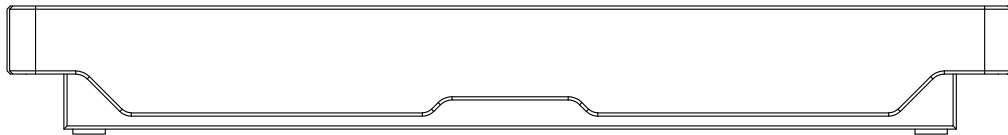

14P

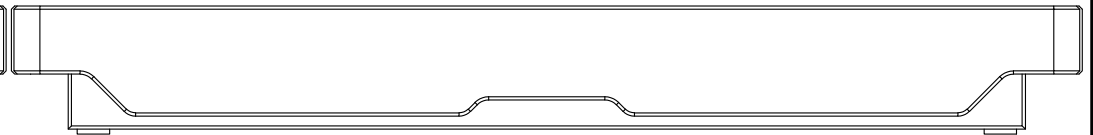

15P

TOLERANCE

X.X ±0.30
X.XX ±0.20
X.XXX ±0.10
Angle ±2°

TITLE:

PAL2.0 LOCK

DRAWN: *XYH* 2023.04.06

CHECKED:

APPROVED:

KONNRA 东莞市康瑞电子有限公司
DongGuan Konnra Electronics Co.,Ltd.

PART NO.:H202201**2411A



NEW DWG

XYH

2023.04.06

MARK

REVISION DESCRIPTION

SIGNATURE

DATE

UNIT:mm

SCALE:1:1

SHEET:2/2

PROJECTION



REV.:A

DRAWING NO.:2022H111-A-S

RoHS
COMPLIANT

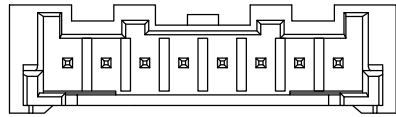

8P View

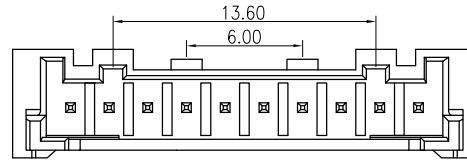

10P-15P View

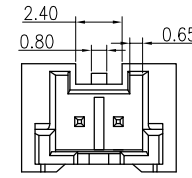

2P View

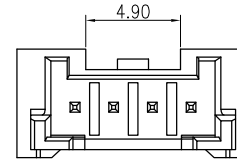
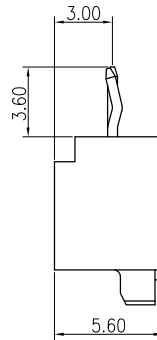
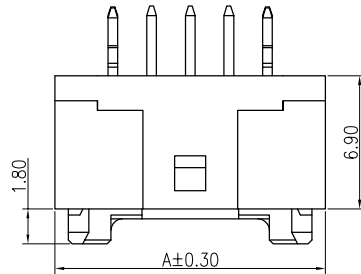

4P View

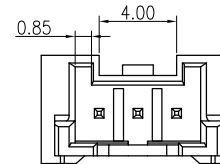
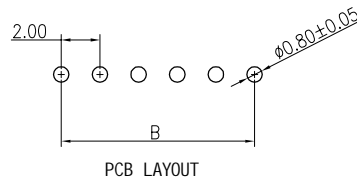
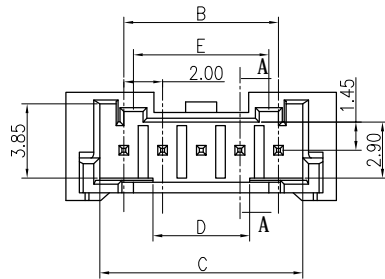

3P View

◆ SPECIFICATIONS

- Current rating: 3A (AWG #24)AC, DC
- Voltage rating: 250V AC,DC
- Temperature range: -40°C ~ +105°C
- Insulation resistance: 1000MΩ Min.
- Withstanding voltage: 800V AC/ minute.
- Contact resistance: 20mΩ Max.

Material:

Insulator: Nylon 9T UL 94V-0

Pin: Brass

Plating: Tin plated over Nickel

Suitable: KR2014 series Housing

Ordering Code:

C2014VD 1** 11 M01 03 P A

102: 2P

115: 15P



11: PA9T Natural

P: Bag
M01: Tin Plating

15P	34.00	28.00	30.50	23.00	13.60
14P	32.00	26.00	28.50	21.00	13.60
13P	30.00	24.00	26.50	19.00	13.60
12P	28.00	22.00	24.50	17.00	13.60
11P	26.00	20.00	22.50	15.00	13.60
10P	24.00	18.00	20.50	13.00	13.60
9P	22.00	16.00	18.50	11.00	7.00
8P	20.00	14.00	16.50	9.00	7.00
7P	18.00	12.00	14.50	7.00	7.00
6P	16.00	10.00	12.50	5.00	7.00
5P	14.00	8.00	10.50	5.00	7.00
4P	12.00	6.00	8.50	5.00	---
3P	10.00	4.00	6.50	1.00	---
2P	8.00	2.00	4.50	---	---
PIN	A	B	C	D	E



Correct the part number code

Arvin

2022.05.31

TOLERANCE

TITLE:
PA2.0 DIP 180° Wafer
(Non-Pillar)

DRAWN: Shen 2021.09.29

KONNRA 东莞市康瑞电子有限公司
DongGuan Konnra Electronics Co., Ltd.



Uniformly arrange the drawings

Shen

2021.09.29

X.X ±0.30
X.XX ±0.25
X.XXX ±0.10
Angle ±2°

CHECKED:



The First Issue(For ZHONG KE)

ZZN

2021.06.29

APPROVED:

PART NO.: C2014VD1**11M0103PA

MARK

REVISION DESCRIPTION

SIGNATURE

DATE

UNIT: mm SCALE: 1:1

SHEET: 1/1

PROJECTION

REV.: A3

DRAWING NO.: 2014WVFD03-A-S

1

2

3

4

5

6

7

8

9

RoHS
COMPLIANT

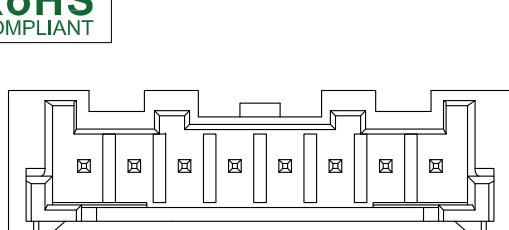

8P View

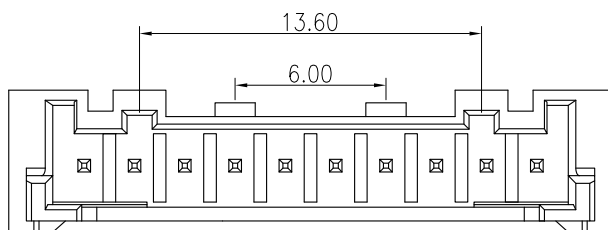

10P-15P View

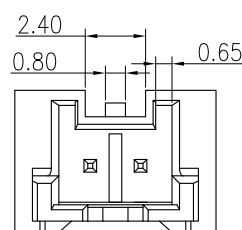

2P View

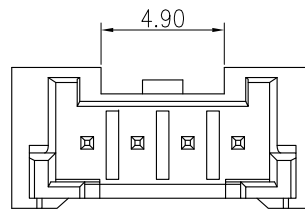
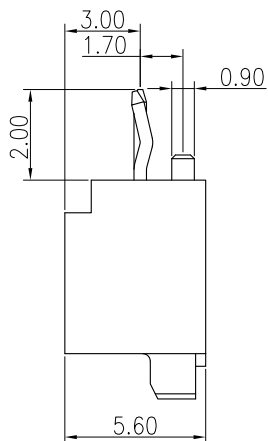
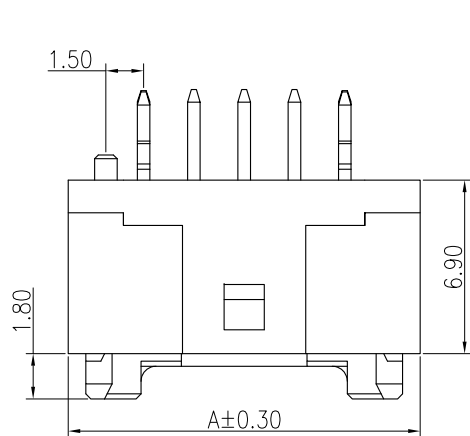

4P View

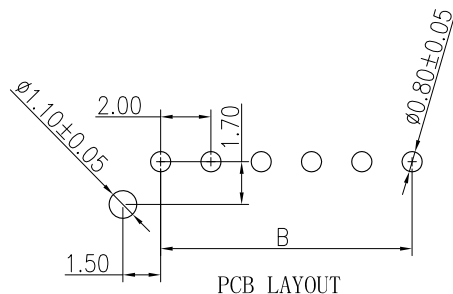
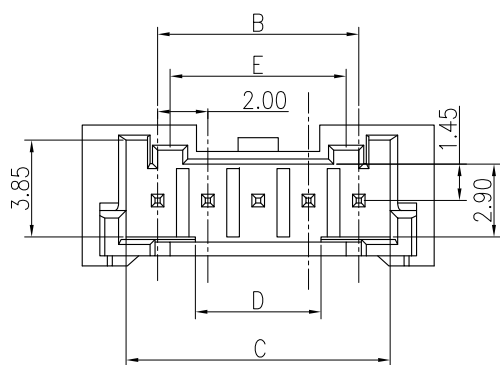

PCB LAYOUT

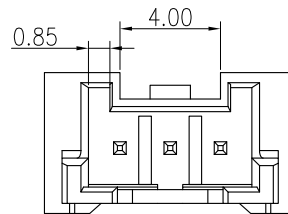

3P View

◆ SPECIFICATIONS

- Current rating: 3A (AWG #24)AC, DC
- Voltage rating: 250V AC,DC
- Temperature range: -40°C ~ +105°C
- Insulation resistance: 1000MΩ Min.
- Withstanding voltage: 800V AC/ minute.
- Contact resistance: 20mΩ Max.

Material:

Insulator: Nylon 9T UL 94V-0

Pin: Brass

Plating: Tin plated over Nickel

Suitable: KR2014 series Housing

PART NO: C2014VD1**11M0102PA

02: 2P
16: 16P

P: BAG

11: PA9T Natural

M01: Matte Tin

15P	34.00	28.00	30.50	23.00	13.60
14P	32.00	26.00	28.50	21.00	13.60
13P	30.00	24.00	26.50	19.00	13.60
12P	28.00	22.00	24.50	17.00	13.60
11P	26.00	20.00	22.50	15.00	13.60
10P	24.00	18.00	20.50	13.00	13.60
9P	22.00	16.00	18.50	11.00	7.00
8P	20.00	14.00	16.50	9.00	7.00
7P	18.00	12.00	14.50	7.00	7.00
6P	16.00	10.00	12.50	5.00	7.00
5P	14.00	8.00	10.50	5.00	7.00
4P	12.00	6.00	8.50	5.00	—
3P	10.00	4.00	6.50	1.00	—
2P	8.00	2.00	4.50	—	—
PIN	A	B	C	D	E

MARK	REVISION DESCRIPTION	SIGNATURE	DATE
A3	Uniformly arrange the drawings	Shen	2021.9.23
A2	Change the part number and frame format	Ru yi	2020.3.10

TOLERANCE
X.X ±0.30
X.XX ±0.25
X.XXX ±0.10
Angle ±2°

TITLE:
PA2.0 DIP 180° WF
Short needle 2.0

DRAWN: Shen 2021.09.23
CHECKED:
APPROVED:
UNIT:mm SCALE:1/1 SHEET:1/1 PROJECTION

KONNRA 东莞市康瑞电子有限公司 DongGuan Konnra Electronics Co.,Ltd.	
PART NO.: C2014VD1**11M0102PA	
REV.: A3	DRAWING NO.: 2014WFVD02-A-S

RoHS
COMPLIANT

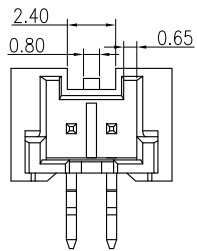

2P View

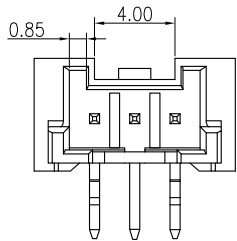

3P View

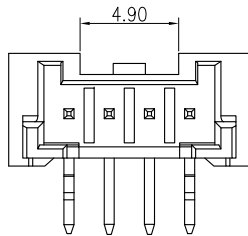

4P View

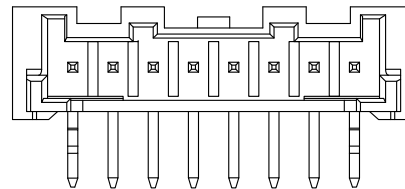

8P View

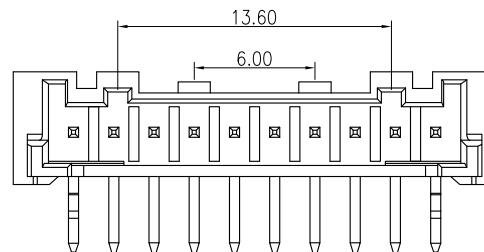
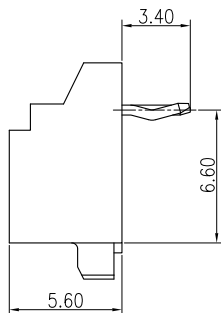
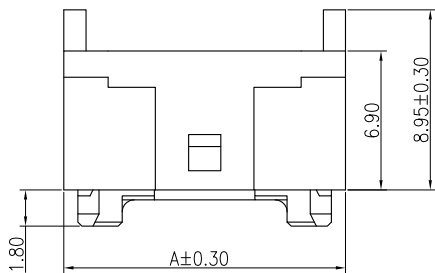

10P-15P View

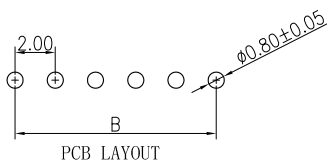
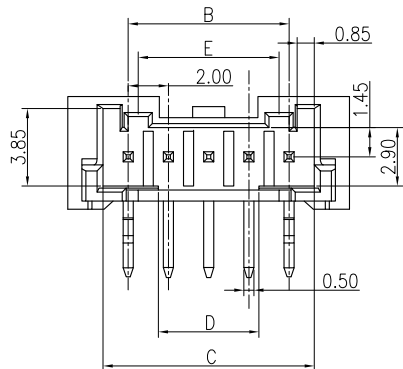

◆ SPECIFICATIONS

- Current rating: 3A (AWG #24)AC, DC
- Voltage rating: 250V AC,DC
- Temperature range: -40°C ~ +105°C
- Insulation resistance: 1000MΩ Min.
- Withstanding voltage: 800V AC/ minute.
- Contact resistance: 10mΩ Max.

Material:

Insulator: Nylon 9T UL 94V-0

Pin: Brass

Plating: Tin plated over Nickel

Suitable: KR2014 series Housing

PART NO: C2014RD1**11M0101PA

02: 2P

16: 16P

PE-BAG

11: PA9T Natural

M01: Matte Tin

15P	34.00	28.00	30.50	23.00	13.60
14P	32.00	26.00	28.50	21.00	13.60
13P	30.00	24.00	26.50	19.00	13.60
12P	28.00	22.00	24.50	17.00	13.60
11P	26.00	20.00	22.50	15.00	13.60
10P	24.00	18.00	20.50	13.00	13.60
9P	22.00	16.00	18.50	11.00	7.00
8P	20.00	14.00	16.50	9.00	7.00
7P	18.00	12.00	14.50	7.00	7.00
6P	16.00	10.00	12.50	5.00	7.00
5P	14.00	8.00	10.50	5.00	7.00
4P	12.00	6.00	8.50	5.00	—
3P	10.00	4.00	6.50	1.00	—
2P	8.00	2.00	4.50	—	—
PIN	A	B	C	D	E

MARK	REVISION DESCRIPTION	SIGNATURE	DATE
A3	Uniformly arrange the drawings	Shen	2021.9.23
A2	Change the part number and frame format	Ru yi	2020.3.10

TOLERANCE
X.X ±0.30
X.XX ±0.25
X.XXX ±0.10
Angle ±2°

TITLE:
PA2.0 DIP 90° WF
UNIT:mm
SCALE:1/1

DRAWN: Shen 2021.09.23
CHECKED:
APPROVED:
SHEET:1/1
PROJECTION

KONNRA 东莞市康瑞电子有限公司 DongGuan Konnra Electronics Co.,Ltd.
PART NO.: C2014RD1**11M0101PA
REV.:A3
DRAWING NO.:2014WFHD01-A-S

RoHS
COMPLIANT

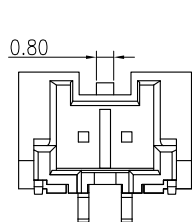

2P View

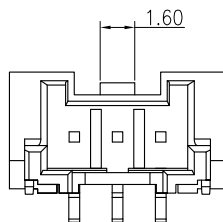

3P View

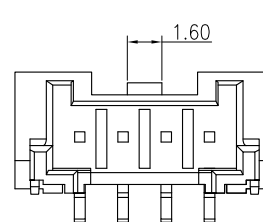

4P View

◆SPECIFICATIONS

- Current rating: 3A (AWG #24)AC, DC
- Voltage rating: 250V AC,DC
- Temperature range: -40°C ~ +105°C
- Insulation resistance:1000MΩ Min.
- Withstanding voltage: 800V AC/ minute.
- Contact resistance: 20mΩ Max.

Material:

Insulator: Nylon 9T UL 94V-0
Pin: Brass

Plating: Tin plated over Nickel
Suitable: KR2014 series Housing

PART NO: C2014VS ***11M0101RA

102: 2P
116: 16P
11: PA9T Natural
M01: Matte Tin

R: REEL

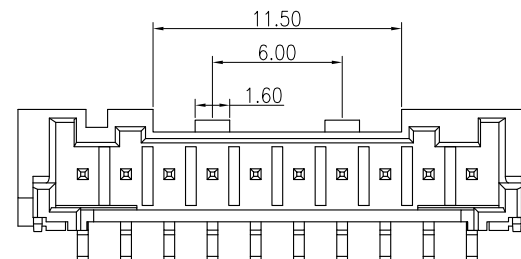
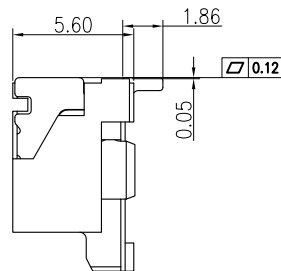
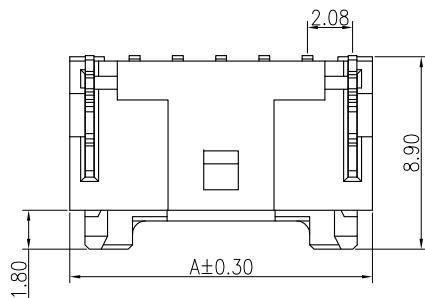

10-15P Two Buckle View

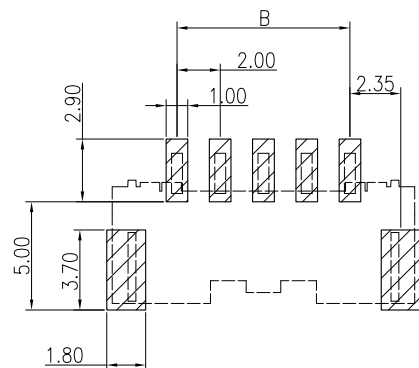
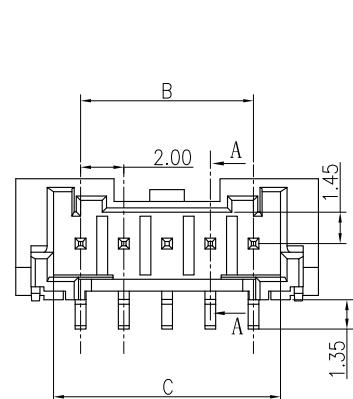

Recommended P.C.B. Layout
Total tolerance:±0.05mm

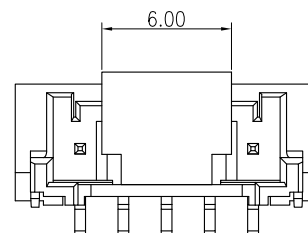

CAP VIEW

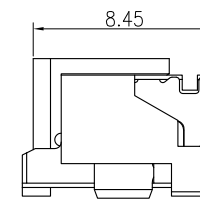

15P	34.00	28.00	30.50
14P	32.00	26.00	28.50
13P	30.00	24.00	26.50
12P	28.00	22.00	24.50
11P	26.00	20.00	22.50
10P	24.00	18.00	20.50
9P	22.00	16.00	18.50
8P	20.00	14.00	16.50
7P	18.00	12.00	14.50
6P	16.00	10.00	12.50
5P	14.00	8.00	10.50
4P	12.00	6.00	8.50
3P	10.00	4.00	6.50
2P	8.00	2.00	4.50
PIN	A	B	C

MARK	REVISION DESCRIPTION	SIGNATURE	DATE	TOLERANCE	TITLE:	DRAWN:	CHECKED:	APPROVED:	REV.:A3	DRAWING NO.:
A3	Uniformly arrange the drawings	Shen	2021.9.23	X.X ±0.30	PA2.0 SMT 180° WF	Shen 2021.09.23				KONNRA 东莞市康瑞电子有限公司 DongGuan Konnra Electronics Co.,Ltd.
A2	Change the part number and frame format	Ru yi	2020.3.10	X.XX ±0.25						
				X.XXX ±0.10						
				Angle ±2°	UNIT:mm	SCALE:1/1	SHEET:1/1	PROJECTION		DRAWING NO.:2014WFVS01-A-S

RoHS
COMPLIANT

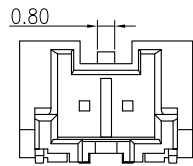

2P View

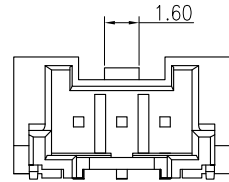

3P View

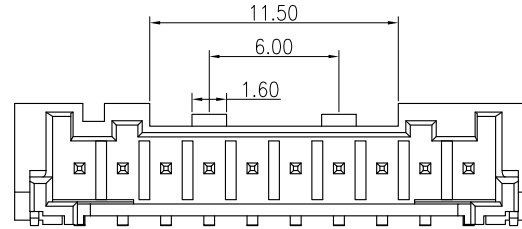

10-15P Two Buckle View

◆SPECIFICATIONS

- Current rating: 3A (AWG #24)AC, DC
- Voltage rating: 250V AC,DC
- Temperature range: -40°C ~ +105°C
- Insulation resistance:1000MΩ Min.
- Withstanding voltage: 800V AC/ minute.
- Contact resistance: 20mΩ Max.

Material:

Insulator: Nylon 9T UL 94V-0
Pin: Brass

Plating: Tin plated over Nickel

Suitable: KR2014 series Housing

PART NO: C2014RS1**11M0101RA

02: 2P

16: 16P

11: PA9T Natural

M01: Matte Tin

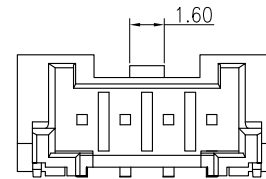
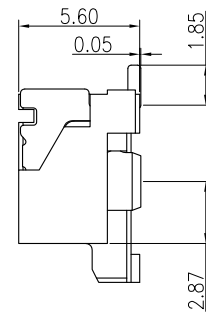
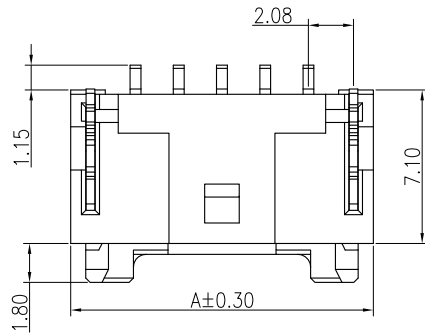

4P View

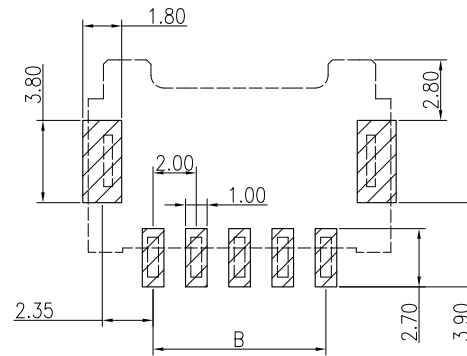
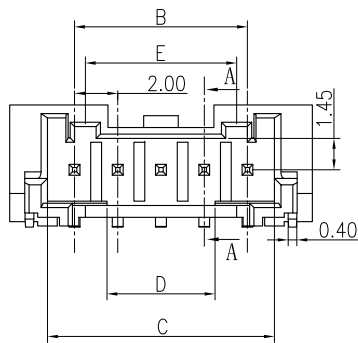

Recommended P.C.B. Layout
Total tolerance:±0.05mm

15P	34.00	28.00	30.50	23.00	13.60
14P	32.00	26.00	28.50	21.00	13.60
13P	30.00	24.00	26.50	19.00	13.60
12P	28.00	22.00	24.50	17.00	13.60
11P	26.00	20.00	22.50	15.00	13.60
10P	24.00	18.00	20.50	13.00	13.60
9P	22.00	16.00	18.50	11.00	7.00
8P	20.00	14.00	16.50	9.00	7.00
7P	18.00	12.00	14.50	7.00	7.00
6P	16.00	10.00	12.50	5.00	7.00
5P	14.00	8.00	10.50	5.00	7.00
4P	12.00	6.00	8.50	5.00	—
3P	10.00	4.00	6.50	1.00	—
2P	8.00	2.00	4.50	—	—
PIN	A	B	C	D	E

MARK	REVISION DESCRIPTION	SIGNATURE	DATE	TOLERANCE	TITLE:	UNIT:mm	SCALE:1/1	SHEET:1/1	PROJECTION	REV.:A3	DRAWING NO.:2014WFHS02-A-S
A3	Uniformly arrange the drawings	Shen	2021.9.23	X.X ±0.30	PA2.0 SMT 90° WF	DRAWN: Shen 2021.09.23	CHECKED:	APPROVED:		KONNRA 东莞市康瑞电子有限公司 DongGuan Konnra Electronics Co.,Ltd.	
A2	Change the part number and frame format	Ru yi	2020.3.10	X.XX ±0.25							
				X.XXX ±0.10							
				Angle ±2°						PART NO.:C2014RS1**11M0101*A	

RoHS
COMPLIANT

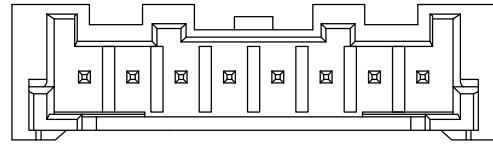

8P View

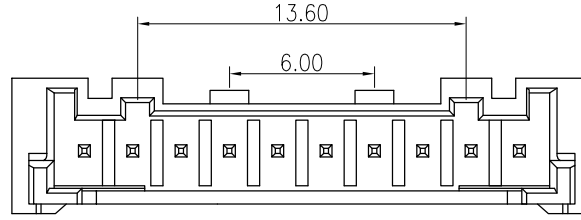

10P-15P View

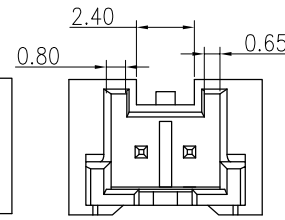

2P View

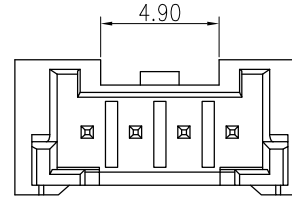
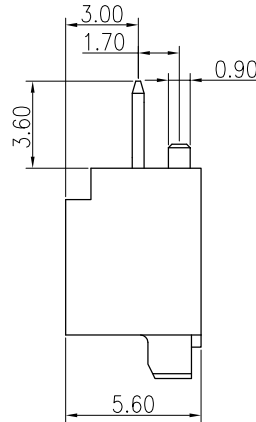
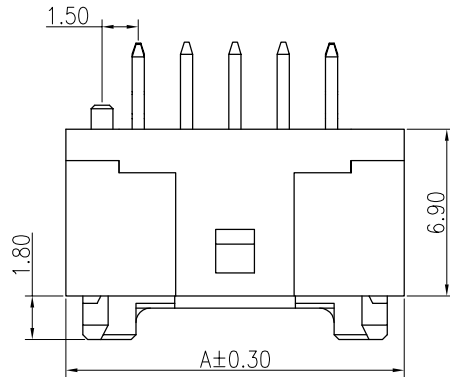

4P View

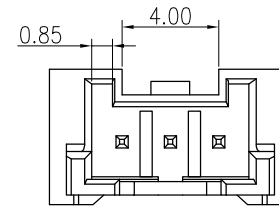

3P View

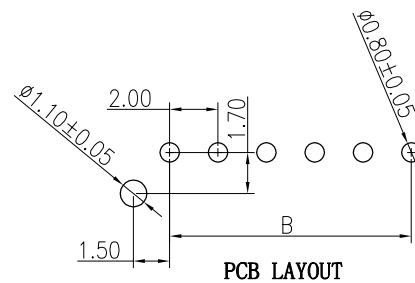
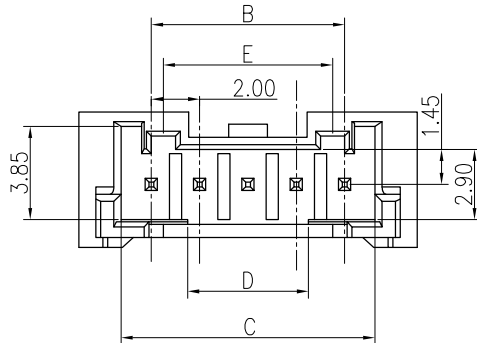

PCB LAYOUT

◆SPECIFICATIONS

- Current rating: 3A (AWG #24)AC, DC
- Voltage rating: 250V AC,DC
- Temperature range: -40°C ~ +105°C
- Insulation resistance:1000MΩ Min.
- Withstanding voltage: 800V AC/ minute.
- Contact resistance: 20mΩ Max.

Material:

Insulator: Nylon 9T UL 94V-0

Pin: Brass

Plating: Tin plated over Nickel

Suitable: KR2014 series Housing

PART NO: C2014VD1**11M0107PA

02: 2P

16: 16P

11: PA9T Natural

M01: Matte Tin

P: BAG

15P	34.00	28.00	30.50	23.00	13.60
14P	32.00	26.00	28.50	21.00	13.60
13P	30.00	24.00	26.50	19.00	13.60
12P	28.00	22.00	24.50	17.00	13.60
11P	26.00	20.00	22.50	15.00	13.60
10P	24.00	18.00	20.50	13.00	13.60
9P	22.00	16.00	18.50	11.00	7.00
8P	20.00	14.00	16.50	9.00	7.00
7P	18.00	12.00	14.50	7.00	7.00
6P	16.00	10.00	12.50	5.00	7.00
5P	14.00	8.00	10.50	5.00	7.00
4P	12.00	6.00	8.50	5.00	---
3P	10.00	4.00	6.50	1.00	---
2P	8.00	2.00	4.50	---	---
PIN	A	B	C	D	E

F				TOLERANCE	TITLE:	DRAWN: <i>3S3 2022.03.03</i>		KONNRA 东莞市康瑞电子有限公司	
				X.X ±0.30	PA2.0 DIP 180° WF No K	CHECKED:		DongGuan Konnra Electronics Co.,Ltd.	
				X.XX ±0.25		APPROVED:		PART NO.: C2014VD1**11M0107PA	
				X.XXX ±0.10		UNIT:mm	SCALE:1/1	SHEET:1/1	PROJECTION
	MARK	REVISION DESCRIPTION	SIGNATURE	DATE	Angle ±2°				
	1	2	3	4	5	6	7	8	9

RoHS
COMPLIANT

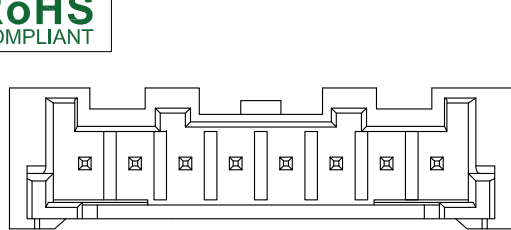

8P View

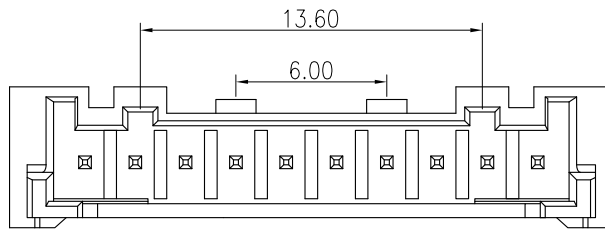

10P-15P View

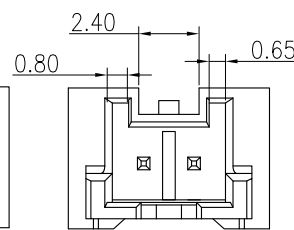

2P View

◆ SPECIFICATIONS

- Current rating: 3A (AWG #24)AC, DC
- Voltage rating: 250V AC,DC
- Temperature range: -40°C ~ +105°C
- Insulation resistance: 1000MΩ Min.
- Withstanding voltage: 800V AC/ minute.
- Contact resistance: 20mΩ Max.

Material:

Insulator: Nylon 9T UL 94V-0

Pin: Brass

Plating: Tin plated over Nickel

Suitable: KR2014 series Housing

PART NO: C2014VD1**11M0101PA

02: 2P P: BAG
16: 16P

11: PA9T Natural

M01: Matte Tin

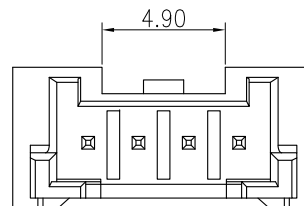
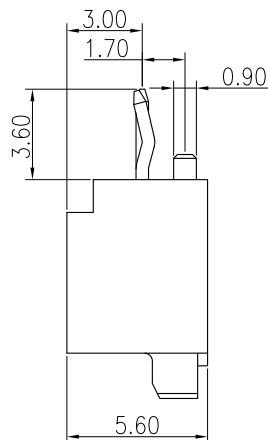
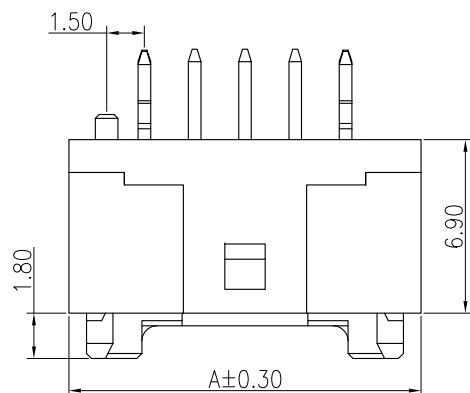

4P View

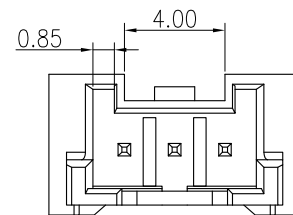

3P View

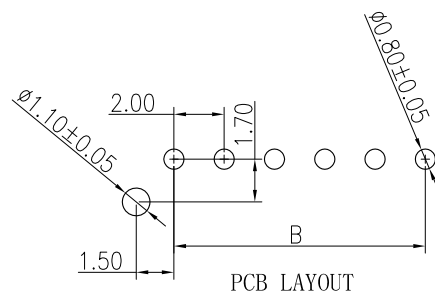
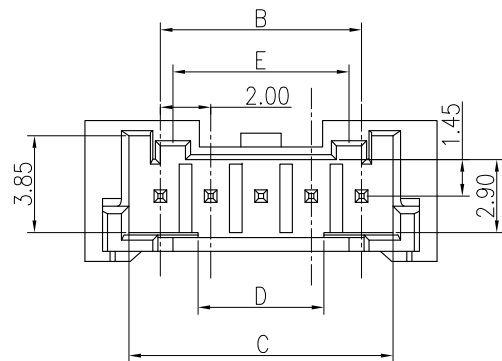

PCB LAYOUT

15P	34.00	28.00	30.50	23.00	13.60
14P	32.00	26.00	28.50	21.00	13.60
13P	30.00	24.00	26.50	19.00	13.60
12P	28.00	22.00	24.50	17.00	13.60
11P	26.00	20.00	22.50	15.00	13.60
10P	24.00	18.00	20.50	13.00	13.60
9P	22.00	16.00	18.50	11.00	7.00
8P	20.00	14.00	16.50	9.00	7.00
7P	18.00	12.00	14.50	7.00	7.00
6P	16.00	10.00	12.50	5.00	7.00
5P	14.00	8.00	10.50	5.00	7.00
4P	12.00	6.00	8.50	5.00	—
3P	10.00	4.00	6.50	1.00	—
2P	8.00	2.00	4.50	—	—
PIN	A	B	C	D	E

MARK	REVISION DESCRIPTION	SIGNATURE	DATE	TOLERANCE	TITLE:	DRAWN:	CHECKED:	APPROVED:	REV.:A3	DRAWING NO.:
A3	Uniformly arrange the drawings	Shen	2021.9.23	X.X ±0.30	PA2.0 DIP 180° WF	Shen 2021.09.23			A3	2014WFVD01-A-S
A2	Change the part number and frame format	Ru yi	2020.3.10	X.XX ±0.25						
				X.XXX ±0.10						
				Angle ±2°	UNIT:mm	SCALE:1/1	SHEET:1/1	PROJECTION		

KONNRA 东莞市康瑞电子有限公司
DongGuan Konnra Electronics Co.,Ltd.

PART NO.: C2014VD1**11M0101PA

REV.:A3 DRAWING NO.:2014WFVD01-A-S

RoHS
COMPLIANT

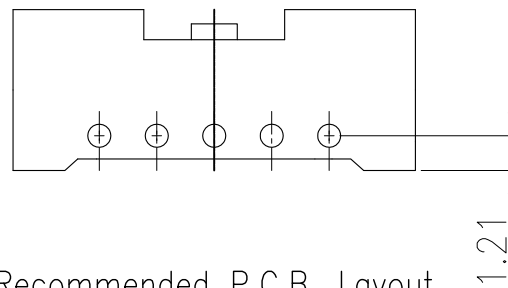
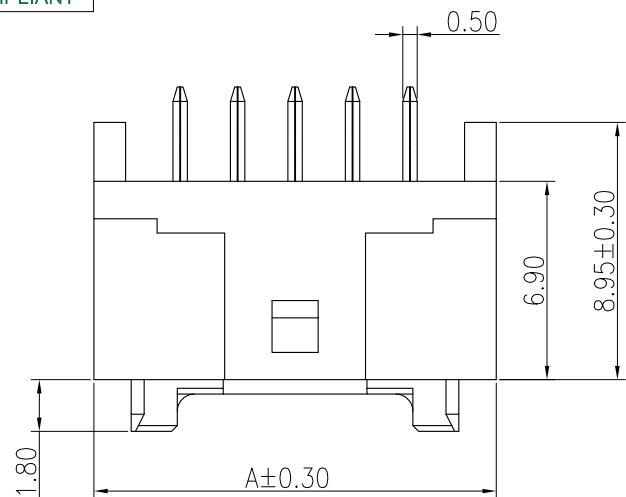

Recommended P.C.B. Layout
Total tolerance: ±0.05mm

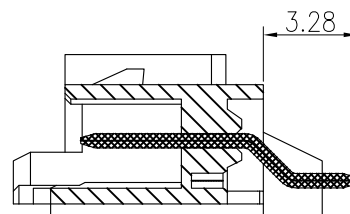

SECTION:A-A

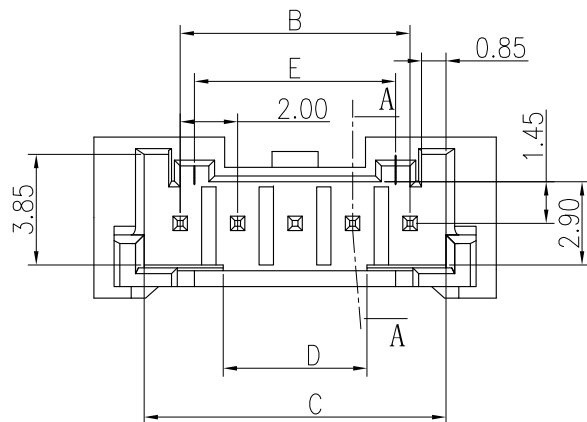
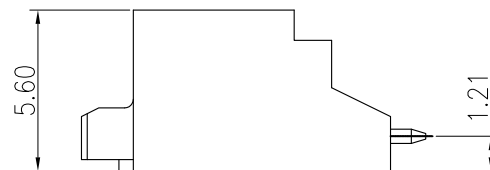

◆SPECIFICATIONS

- Current rating: 3A (AWG #24)AC, DC
- Voltage rating: 250V AC,DC
- Temperature range: -40°C ~ +105°C
- Insulation resistance:1000MΩ Min.
- Withstanding voltage: 800V AC/ minute.
- Contact resistance: 20mΩ Max.

Material:

Insulator: Nylon 9T UL 94V-0
Pin: Brass

Plating: Tin plated over Nickel
Suitable: KR2014 series Housing

PART NO: C2014VD1**11M0106PA

02: 2P
16: 16P
11:PA9T Natural
M01: Matte Tin
P: BAG

15P	34.00	28.00	30.50	23.00	13.60
14P	32.00	26.00	28.50	21.00	13.60
13P	30.00	24.00	26.50	19.00	13.60
12P	28.00	22.00	24.50	17.00	13.60
11P	26.00	20.00	22.50	15.00	13.60
10P	24.00	18.00	20.50	13.00	13.60
9P	22.00	16.00	18.50	11.00	7.00
8P	20.00	14.00	16.50	9.00	7.00
7P	18.00	12.00	14.50	7.00	7.00
6P	16.00	10.00	12.50	5.00	7.00
5P	14.00	8.00	10.50	5.00	7.00
4P	12.00	6.00	8.50	5.00	—
3P	10.00	4.00	6.50	1.00	—
2P	8.00	2.00	4.50	—	—
PIN数	A	B	C	D	E

A3

A2

A1

Add Product Type

MARK

REVISION DESCRIPTION

SIGNATURE

DATE

TOLERANCE

X.X ±0.30

X.XX ±0.25

X.XXX ±0.10

Angle ±2°

TITLE:

PA2.0 DIP 180° WF
_TYPE 6

UNIT:mm

SCALE:N/A

DRAWN:

33/2021.11.15

CHECKED:

APPROVED:

SHEET:1/1

PROJECTION

KONNRA 东莞市康瑞电子有限公司
DongGuan Konnra Electronics Co.,Ltd.

PART NO.:C2014VD1**11M0106PA

REV.:A1

DRAWING NO.:2014WFVD106-A-S

1

2

3

4

5

6

7

8

9

RoHS
COMPLIANT

SPECIFICATIONS

1. Current rating: 3A (AWG #24)AC, DC
2. Voltage rating: 250V AC,DC
3. Temperature range: -40°C ~ +105°C
4. Insulation resistance: 1000MΩ Min.
5. Withstanding voltage: 800V AC/ minute.
6. Contact resistance: 20mΩ Max.

Material:

Insulator: High temperature plastics UL 94V-0
Pin: Brass
Plating: Tin plated over Nickel
Suitable: KR2014 series Housing

PART NO: C2014VD1** **M0105PA
02: 2P P: BAG
16: 16P
13: LCP Natural
48: PA10T Natural
M01: Matte Tin

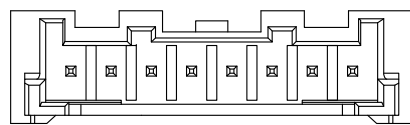

8P View

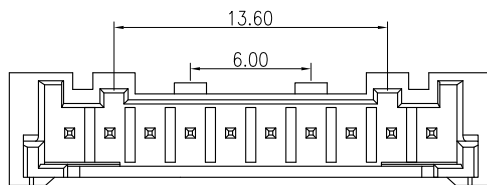

10P-15P View

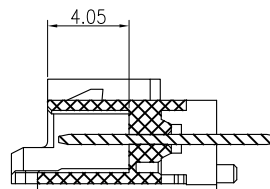
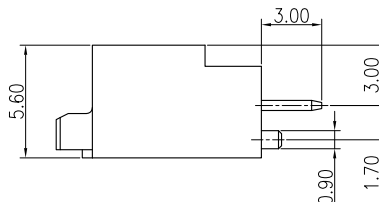
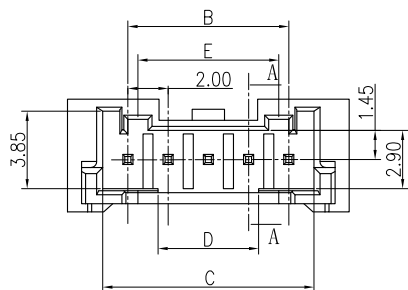
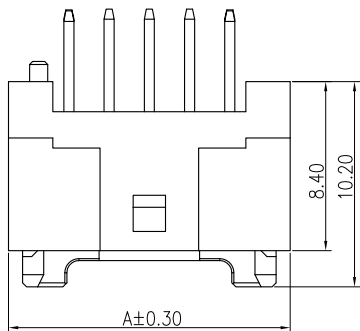

SECTION A-A
SCALE 1:1

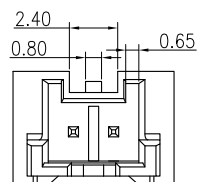

2P View

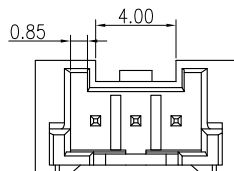

3P View

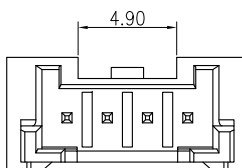

4P View

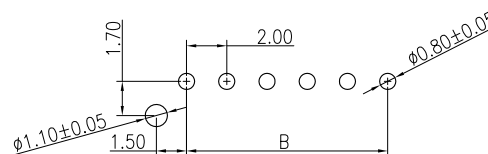

PCB LAYOUT
TOTAL TOLERANCE: ±0.05mm

15P	34.00	28.00	30.50	23.00	13.60
14P	32.00	26.00	28.50	21.00	13.60
13P	30.00	24.00	26.50	19.00	13.60
12P	28.00	22.00	24.50	17.00	13.60
11P	26.00	20.00	22.50	15.00	13.60
10P	24.00	18.00	20.50	13.00	13.60
9P	22.00	16.00	18.50	11.00	7.00
8P	20.00	14.00	16.50	9.00	7.00
7P	18.00	12.00	14.50	7.00	7.00
6P	16.00	10.00	12.50	5.00	7.00
5P	14.00	8.00	10.50	5.00	7.00
4P	12.00	6.00	8.50	5.00	—
3P	10.00	4.00	6.50	1.00	—
2P	8.00	2.00	4.50	—	—
PIN	A	B	C	D	E

A3

A2

A1

MARK

1

2

3

4

5

6

7

8

9

TOLERANCE

X.X ±0.30
X.XX ±0.25
X.XXX ±0.10
Angle ±2°

TITLE:

PA2.0 DIP 180° WF
H=10.20 No K

UNIT:mm

SCALE:1/1

DRAWN:

Arvin 2021.10.29

CHECKED:

APPROVED:

SHEET:1/1

PROJECTION

KONNRA 东莞市康瑞电子有限公司
DongGuan Konnra Electronics Co.,Ltd.

PART NO.:C2014VD1****M0105PA

REV.:A1

DRAWING NO.:2014WFVD105-A-S

F

F

F

RoHS
COMPLIANT

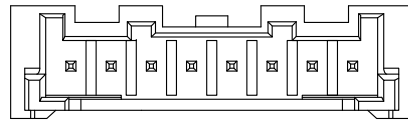

8P View

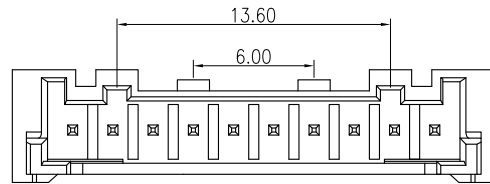
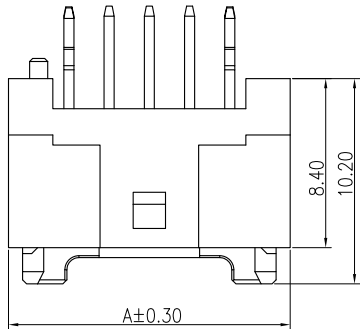

10P-15P View

◆SPECIFICATIONS

- Current rating: 3A (AWG #24)AC, DC
- Voltage rating: 250V AC,DC
- Temperature range: -40°C ~ +105°C
- Insulation resistance:1000MΩ Min.
- Withstanding voltage: 800V AC/ minute.
- Contact resistance: 20m Ω Max.

Material:

Insulator: High temperature plastics UL 94V-0

Pin: Brass

Plating: Tin plated over Nickel

Suitable: KR2014 series Housing

PART NO: C2014VD1** **M0104PA

02: 2P P: BAG
16: 16P
13: LCP Natural
48: PA10T Natural
M01: Matte Tin

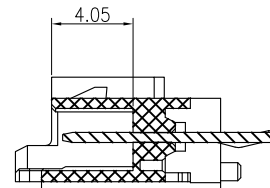
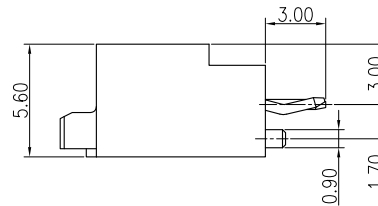
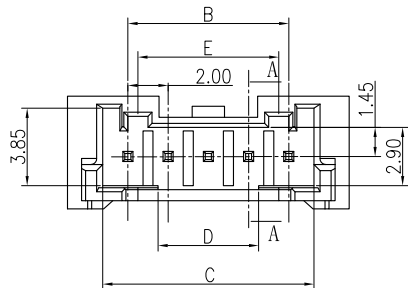

SECTION A-A
SCALE 1:1

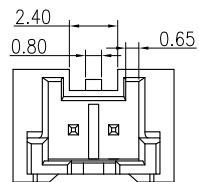

2P View

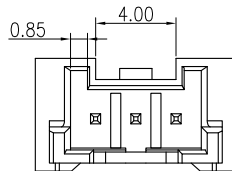

3P View

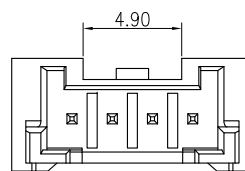

4P View

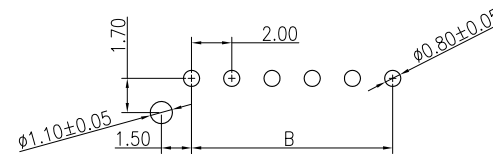

PCB LAYOUT
TOTAL TOLERANCE: ±0.05mm

15P	34.00	28.00	30.50	23.00	13.60
14P	32.00	26.00	28.50	21.00	13.60
13P	30.00	24.00	26.50	19.00	13.60
12P	28.00	22.00	24.50	17.00	13.60
11P	26.00	20.00	22.50	15.00	13.60
10P	24.00	18.00	20.50	13.00	13.60
9P	22.00	16.00	18.50	11.00	7.00
8P	20.00	14.00	16.50	9.00	7.00
7P	18.00	12.00	14.50	7.00	7.00
6P	16.00	10.00	12.50	5.00	7.00
5P	14.00	8.00	10.50	5.00	7.00
4P	12.00	6.00	8.50	5.00	—
3P	10.00	4.00	6.50	1.00	—
2P	8.00	2.00	4.50	—	—
PIN	A	B	C	D	E

A3

A2

A1

MARK

1

2

3

4

5

6

7

8

9

TOLERANCE

X.X ±0.30
X.XX ±0.25
X.XXX ±0.10
Angle ±2°

TITLE:

PA2.0 DIP 180° WF
H=10.20 Have K

DRAWN: Shen 2021.10.12

CHECKED:

APPROVED:

KONNRA 东莞市康瑞电子有限公司
DongGuan Konnra Electronics Co.,Ltd.

PART NO.: C2014VD1****M0104PA

REV.: A1 DRAWING NO.: 2014WFVD104-A-S

UNIT:mm SCALE: 1/1

SHEET: 1/1

PROJECTION

REV.: A1

DRAWING NO.: 2014WFVD104-A-S